

dormakaba pextra Q

Serrated key system

Available
from
January
2024

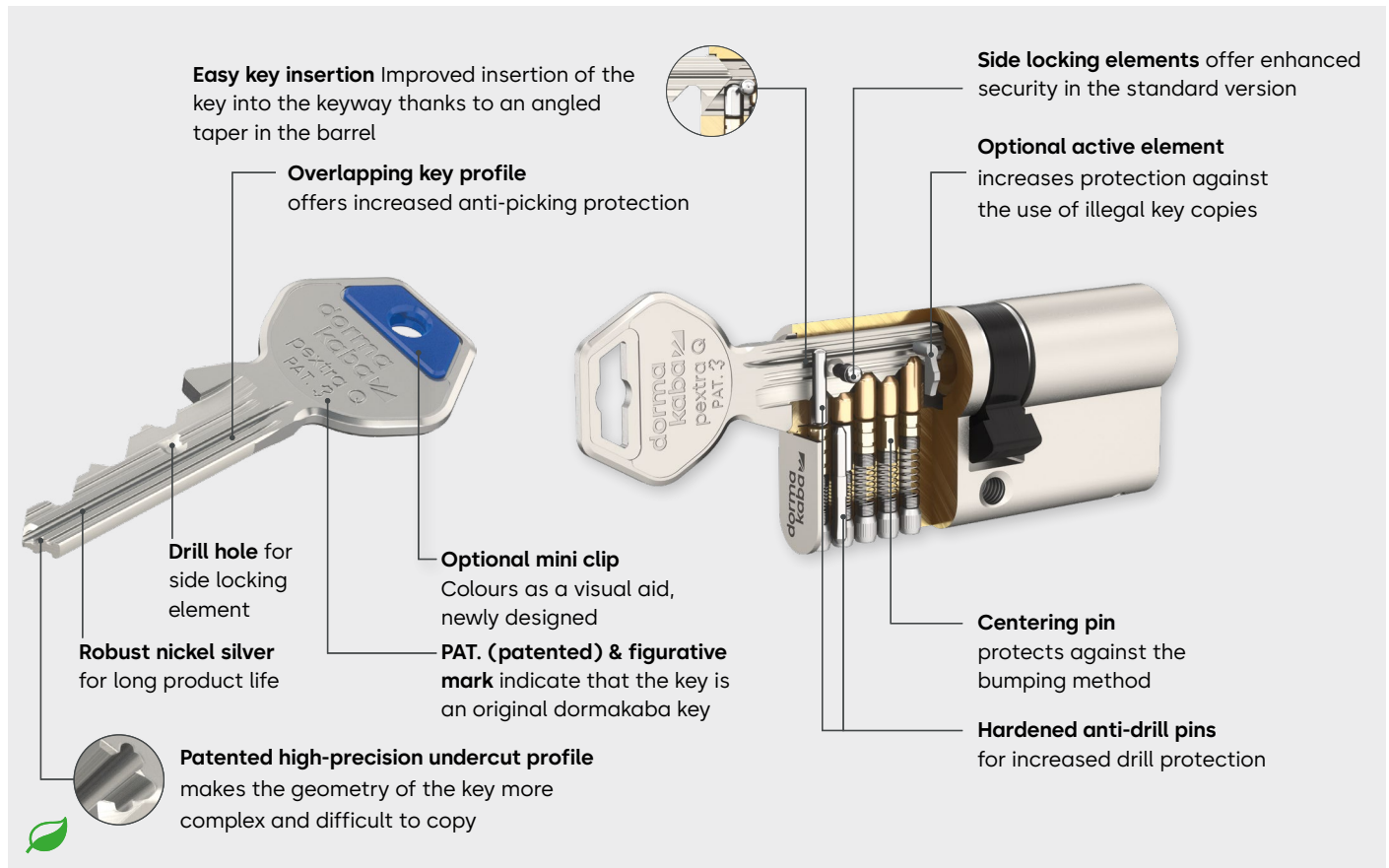

The new dormakaba pextra Q serrated key system provides multiple layers of protection for high-security serial lock cylinders and master key systems. Its versatility makes it ideal for securing and organising access to any building – not only family homes and residential complexes, but also public buildings and industrial properties.

Secure

- Patented high-precision undercut key profile (branch groove) for passive copy protection
- Extremely secure as it complies with relevant standards, such as EN 1303, DIN 18252 and VdS
- Overlapping key profile for better protection against picking
- New serial number range system – every key is unique and can be precisely assigned
- Better anti-drill protection provided by additional hardened steel security elements in the lock cylinder

Flexible

- Flexible in its use with serial keying and with basic to highly complex master key system types
- Newly designed mini clip with colours as a visual aid can be fitted ex works
- Optional security elements for even greater protection
- Special functions for more access options, security and convenience
- Can be combined with electronic systems

Durable

- Long-term protection by European patent EP4204648* – valid until 2042.
- Our systems are additionally marked with a logo that is protected as a figurative mark and that makes them easy to identify. The figurative mark symbolises our patented undercut and shows that the key is an original manufactured by dormakaba.

Security and a variety of options

Standards and certificates

- EN 1303 / DIN 18252 Key Related Security Grade 5 for lock cylinders with five pins and Grade 6 for lock cylinders with five pins + optional profile blocking pin and for lock cylinders with six or seven pins
- EN 1303 / DIN 18252 Attack Resistance Grade D with corresponding door furniture, with steel shim reinforcement in the housing or with a sacrificial cut (SBS)
- VdS-A and VdS-AZ with five pins, VdS-B and VdS-BZ with six pins
- Fire protection as standard; fire resistant (T90) according to EN 1634

Keys with different shapes and functions



Standard key
with angular bow, side locking element and optional mini clip



Key with **TrendKey clip**



Key with **metal clip**



Key with **RFID transponder clip** for integration into electronic access control systems

Colours as a visual aid



The large clips for the **standard key** come in eleven colours and the mini clips come in six colours.



The **TrendKey** is available in dark blue, light blue, red, green, yellow and black.



The **metal clip** comes without a coloured ball as standard. Red, green and black balls are nevertheless available as visual aids.



The **RFID transponder clips** have six coloured ring elements for easier identification.

Free choice of lock cylinders

Our range of lock cylinders covers a wide selection of different types for all kinds of applications. The lock cylinders, cylinders for cabinet locks, key switch cylinders and lift controls can be organised into a master key system. Choose between various cylinder surfaces to harmonise your design.

Any questions? We will be glad to inform you and welcome your contact.

dormakaba Deutschland GmbH | DORMA Platz 1 | DE-58256 Ennepetal | www.dormakaba.de
dormakaba Luxembourg SA | Duchscherstrooss 50 | LU-6868 Wecker | www.dormakaba.lu
dormakaba Austria GmbH | Ulrich-Bremi-Strasse 2 | AT-3130 Herzogenburg | www.dormakaba.at

Added value upon request:

Special functions

If you have specific requirements for your complete master key system or individual doors, take your pick from our comprehensive range of special functions and special designs. For details, please refer to the brochure "Special functions for serrated key systems".

Overview of special functions:

- **Left your key inserted on the inside? No problem!**
Lock cylinder with key override on both sides (BSZ)
- **Attack from outside? Strong resistance from inside.**
Steel reinforcement shims version (LAM)
- **Need to change the keys? No need to also replace the lock cylinder.**
Self-changeable cylinder (SUZ)
- **Staff access? Yes, while unlocked.**
Lock cylinder with personnel key (PS)

Our commitment to sustainability

At dormakaba, we are committed to sustainable development along our entire value chain.

dormakaba can provide Environmental Product Declarations (EPDs) that contain quantified data on the environmental effects of our products and their ecological footprints.

You can find our EPDs and further information on our commitment to sustainability [here](#) or by scanning the QR code.



Environmental product declaration: EPD

- Declaration number:
EPD-DOR-20210194-CBC1-EN
- In line with ISO 14025 and EN 15804+A2
- Publisher and declaration holder:
Institut Bauen und Umwelt e.V.