

Select a Language

- **EN** - Quick Start Guide
- **ES** - Guía de inicio rápido
- **FR** - Guide de démarrage rapide
- **DE** - Schnelle Startanleitung
- **IT** - Guida all'uso rapido
- **PT** - Guia de início rápido
- **PL** - Skrócona instrukcja obsługi

Axessor Apexx Keypad

Quick Start Guide

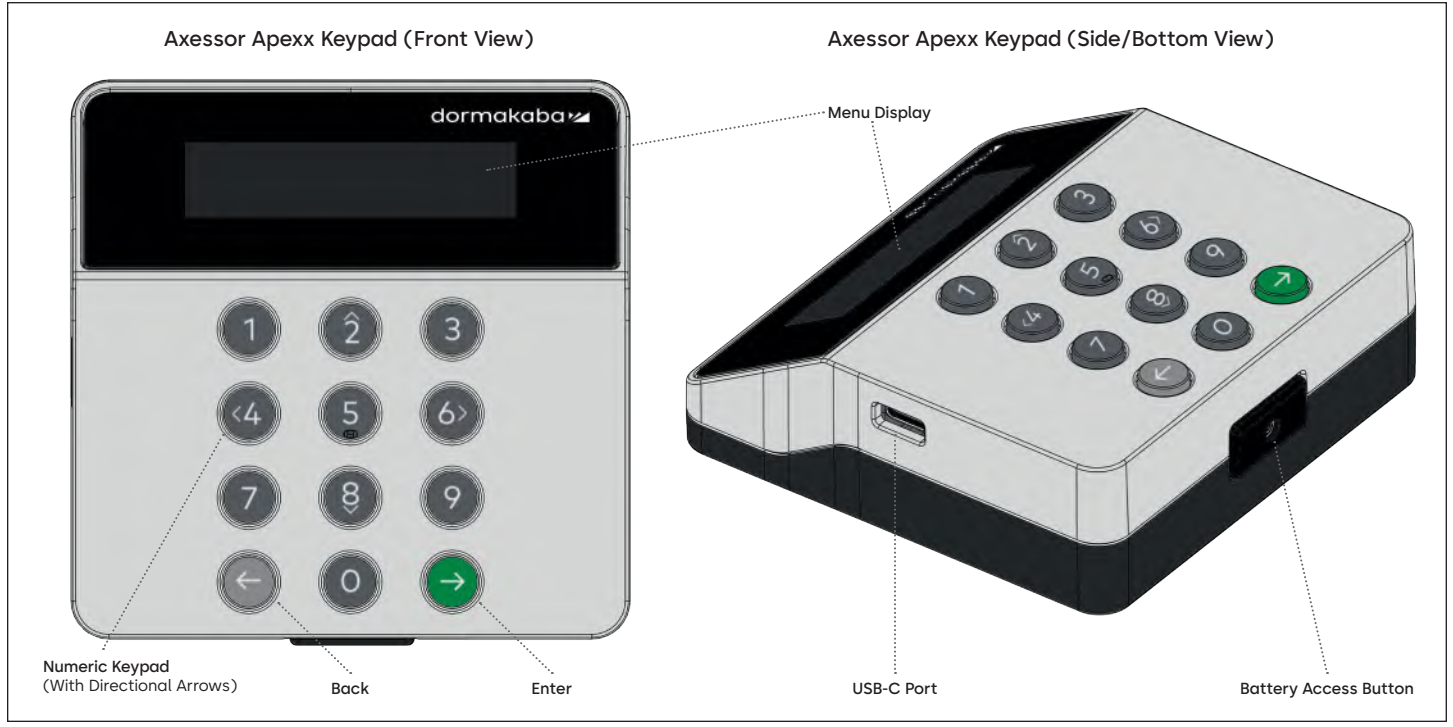

Drill-Deburr-Tap Templates

Axessor Apexx Keypad

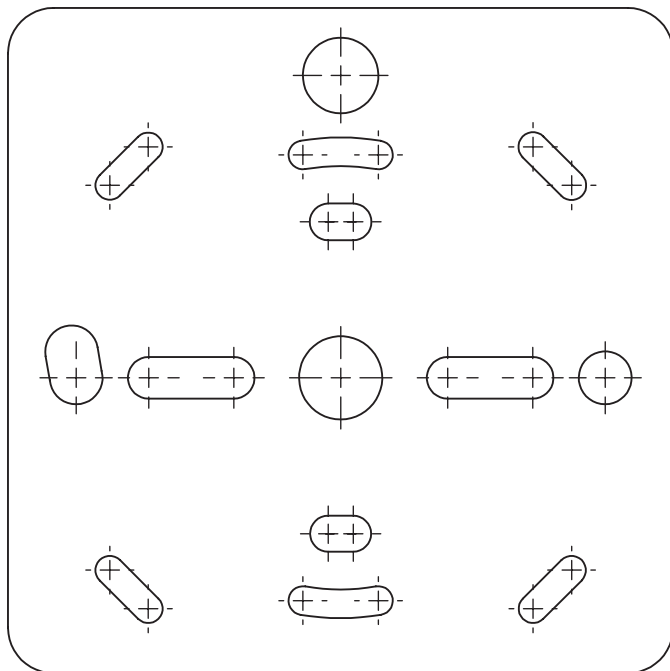

Apexx Series Lock

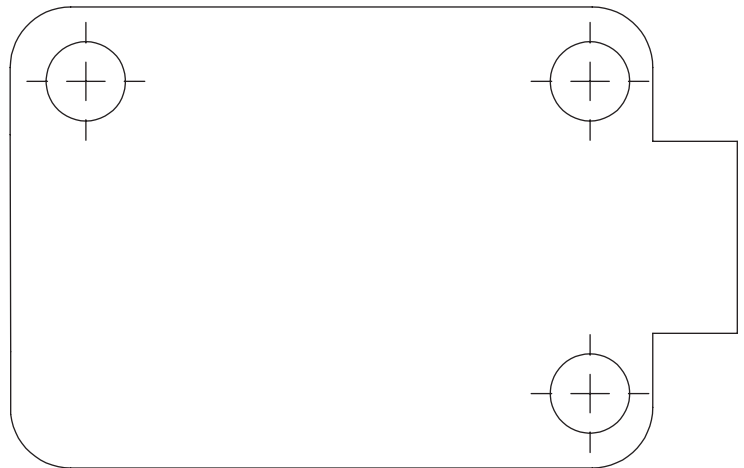

Axessor Apexx Keypad & Apexx Series Lock Installation

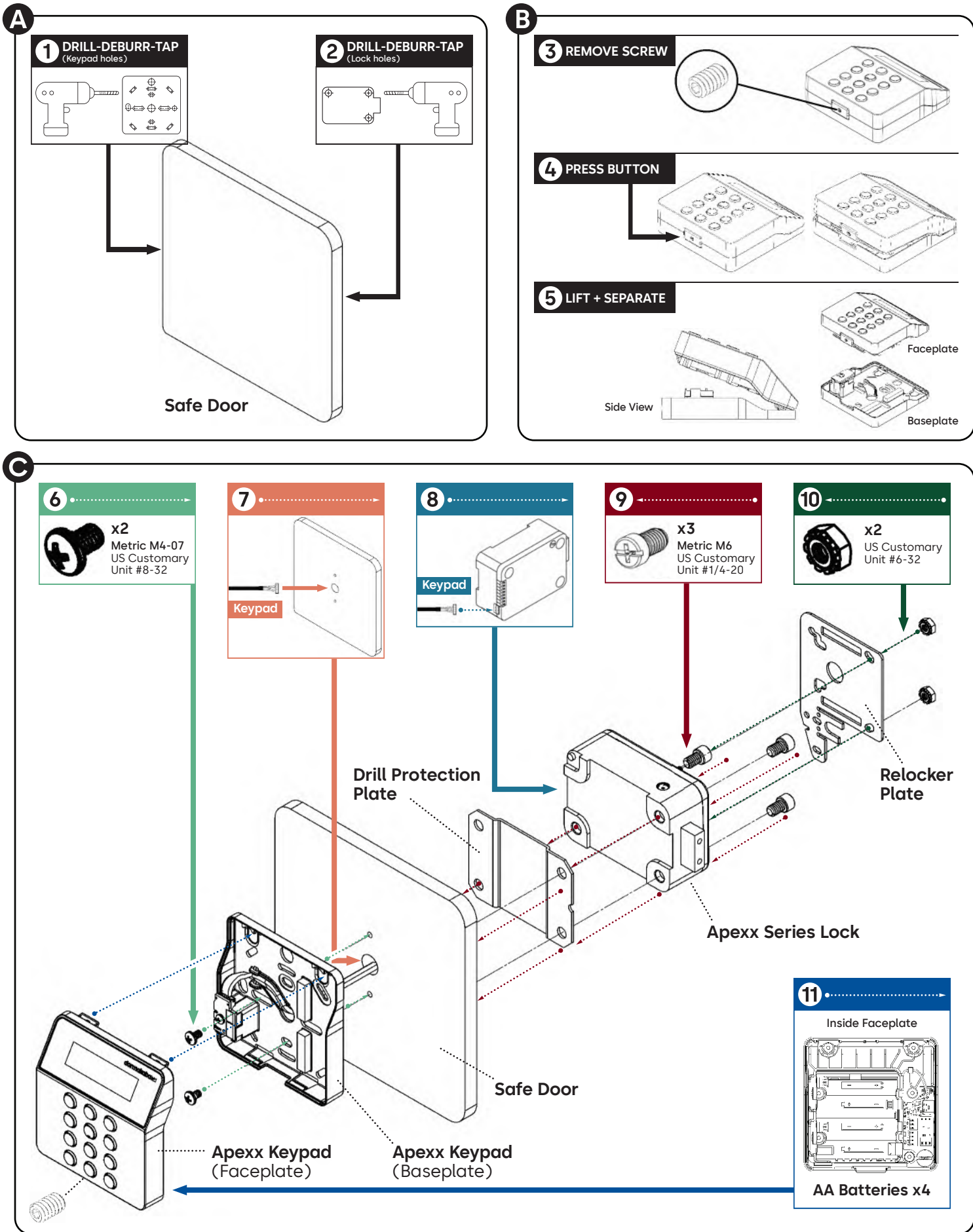

Axessor Apexx Keypad – Basic Functions

1 Install First Lock and Create Admin User

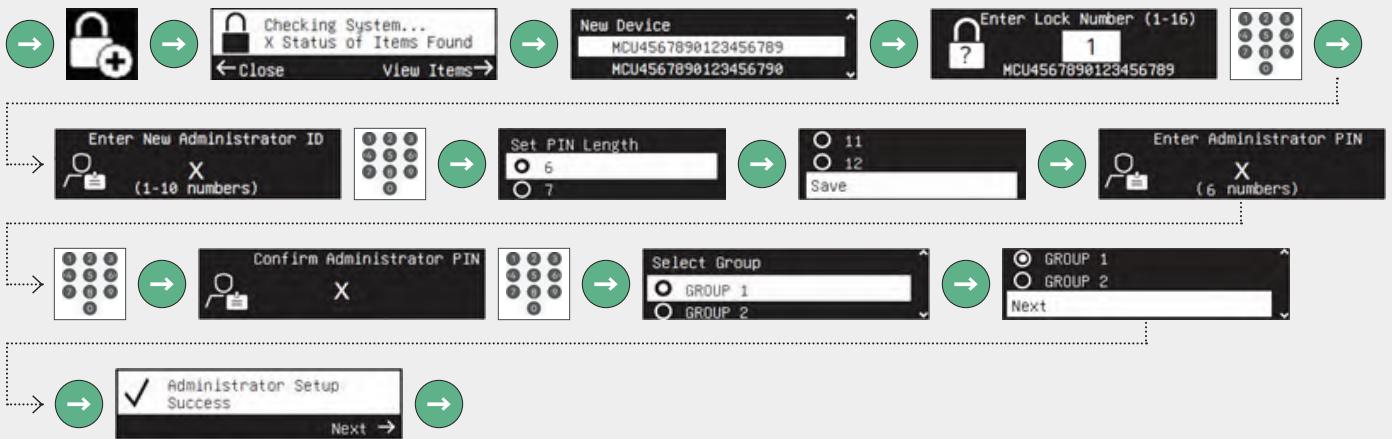

2 Add User

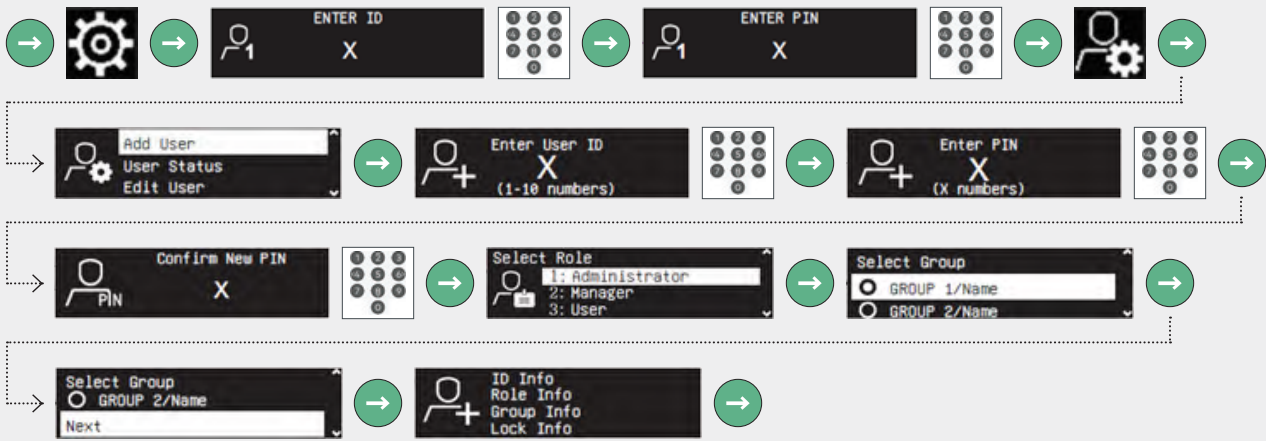

3 Set Time Delay

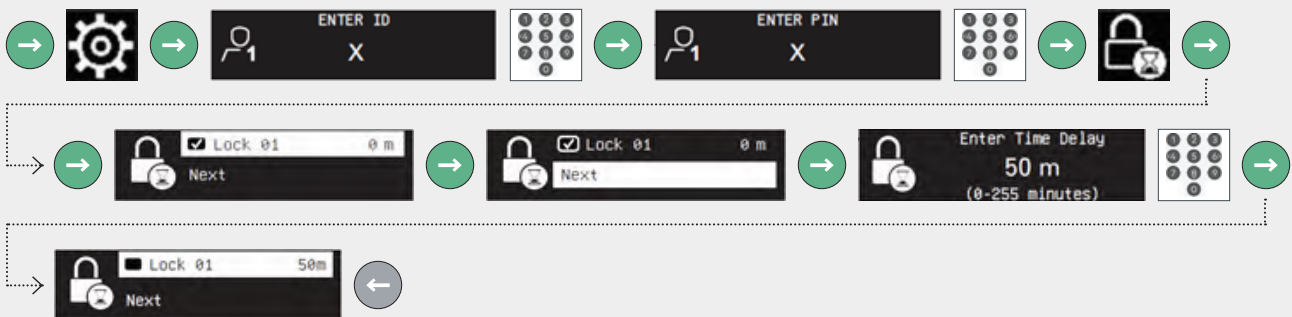

Axessor Apexx Keypad – Basic Functions

4 Change PIN

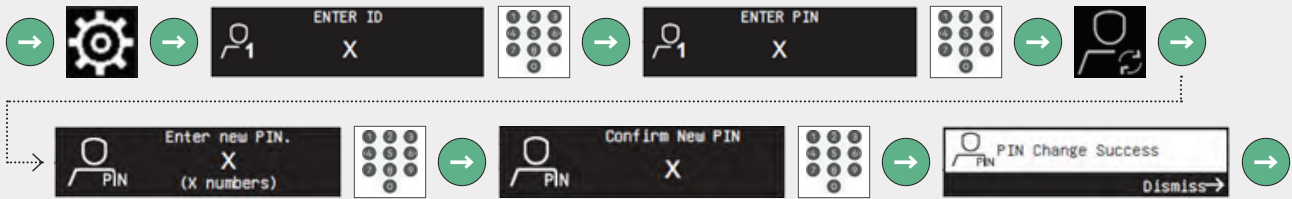

5 Open Lock

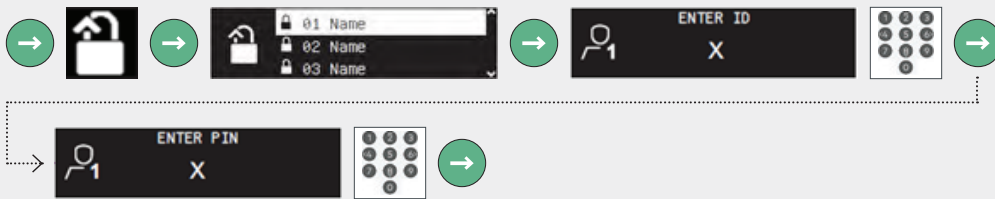

6 System Info Menu

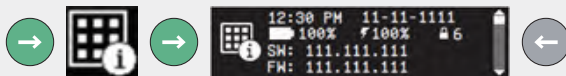

Instructions

For detailed instructions go to: www.dormakaba.us



AXESSOR APEXX
INSTALLATION AND
OPERATION GUIDES

Any questions? We would be happy to advise you.

Contact us: sales.safelocks.us@dormakaba.com

Teclado numérico Axessor Apexx

Guía de inicio rápido

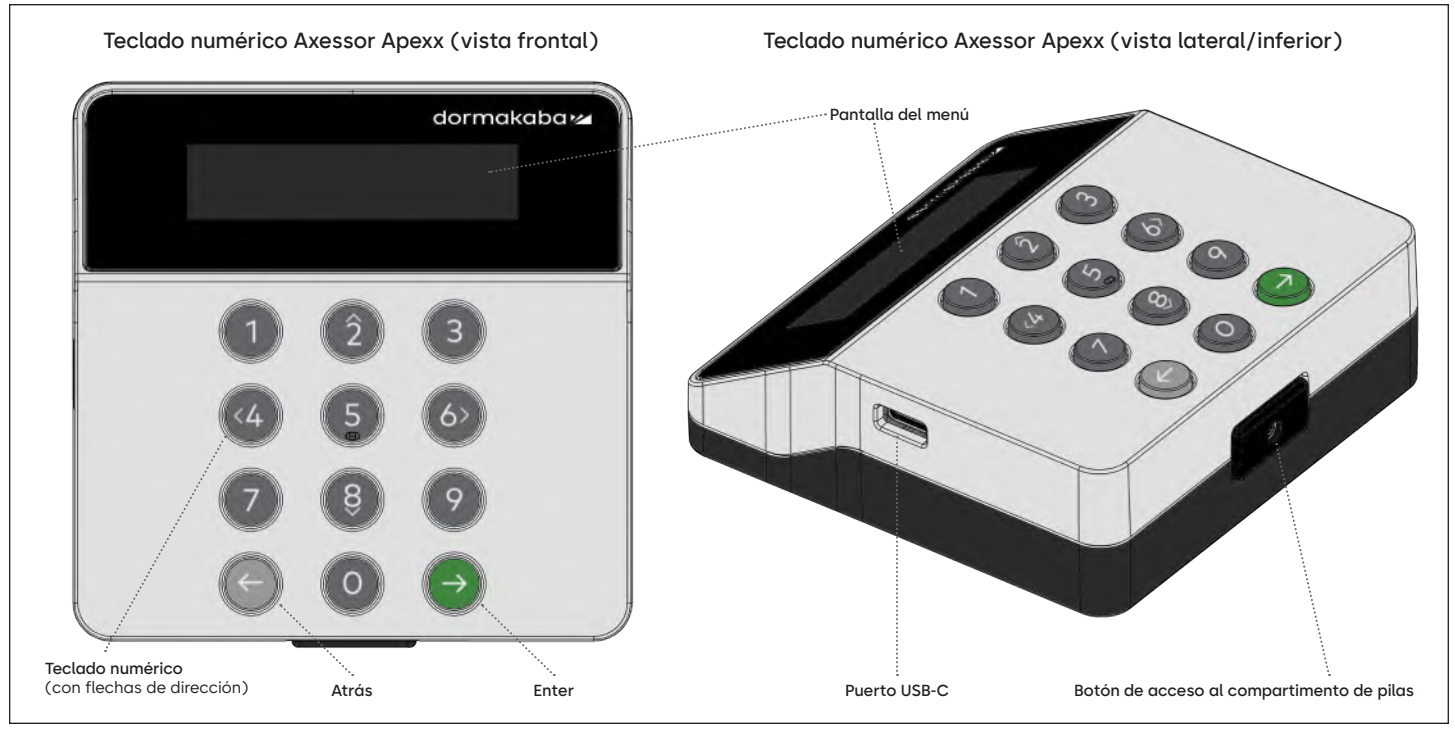

Plantillas de taladrado - desbarbado - roscado

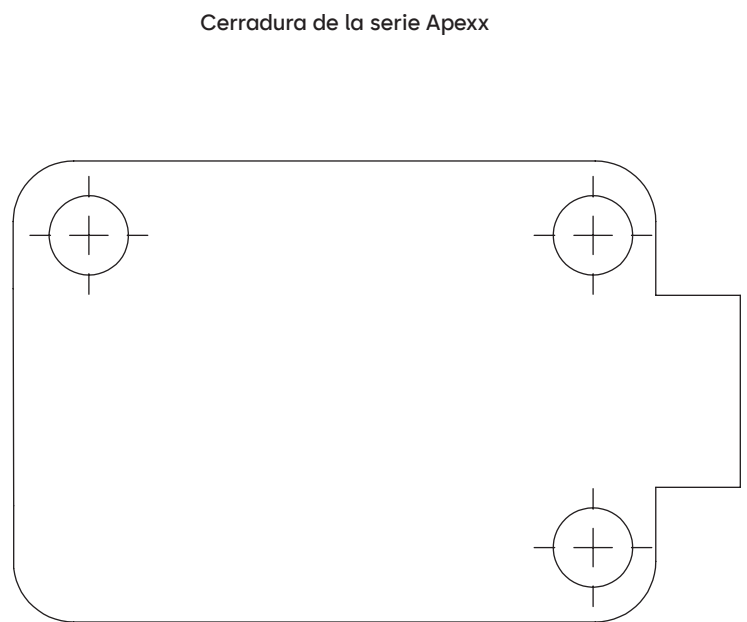
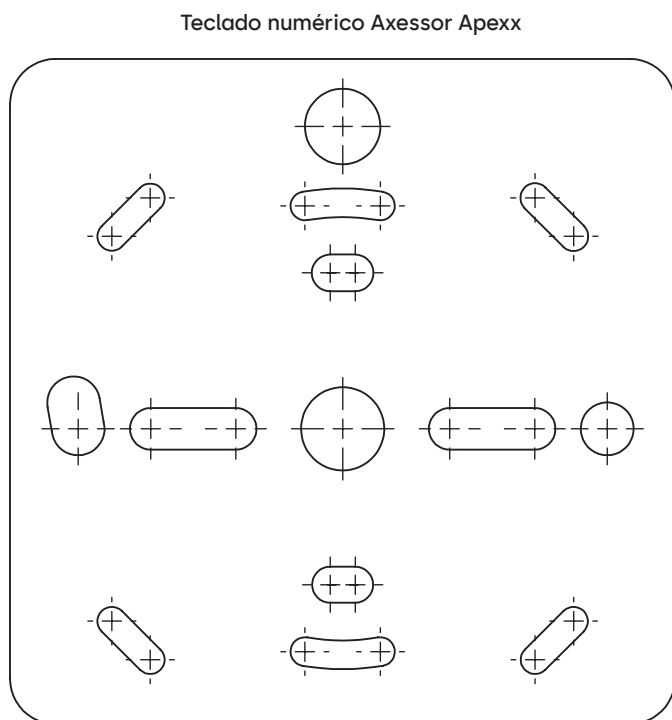

Instalación del teclado numérico Axessor Apexx y de la cerradura de la serie Apexx

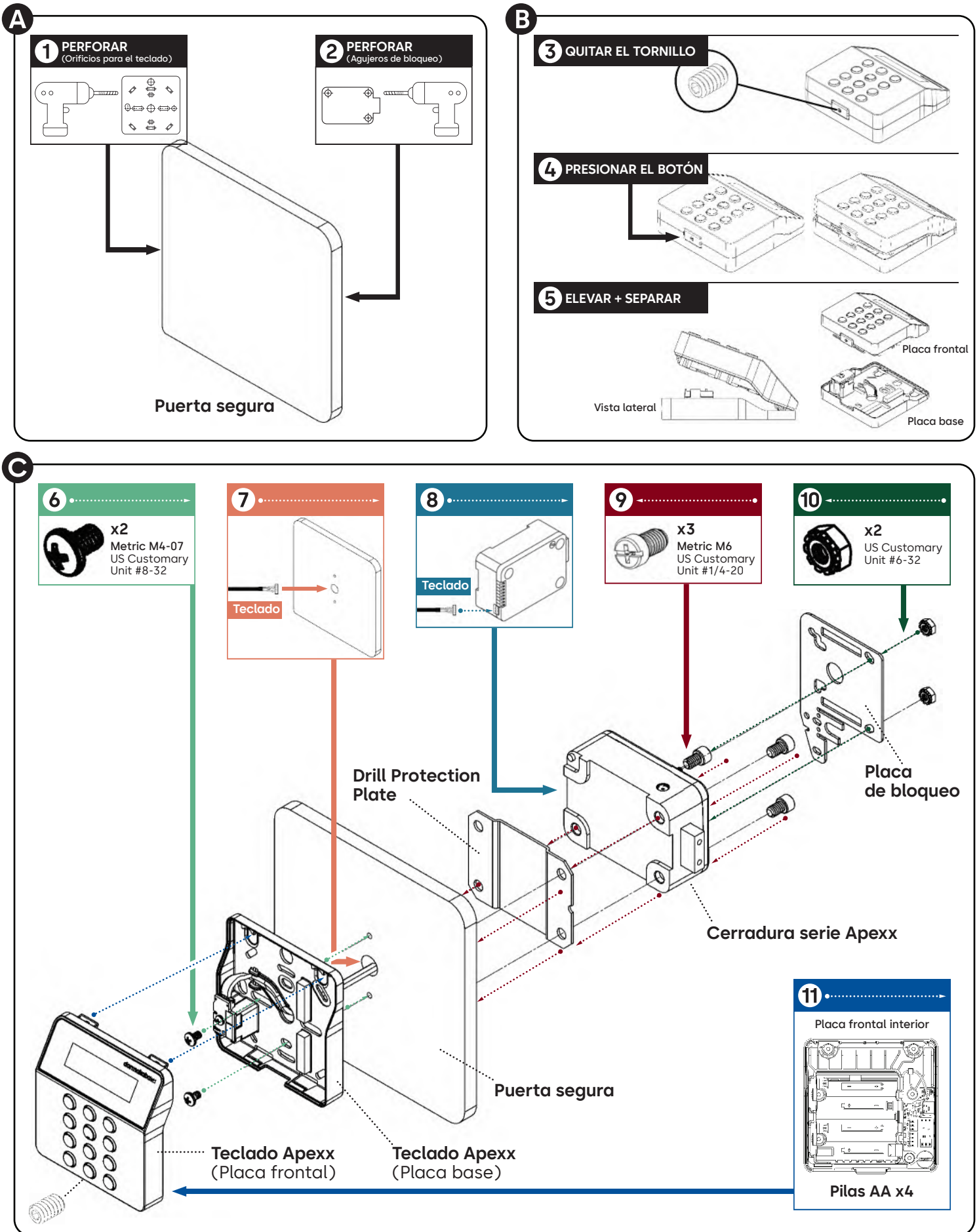

Teclado numérico Axessor Apexx - Funciones básicas

1 Instalar la primera cerradura y crear un usuario administrador

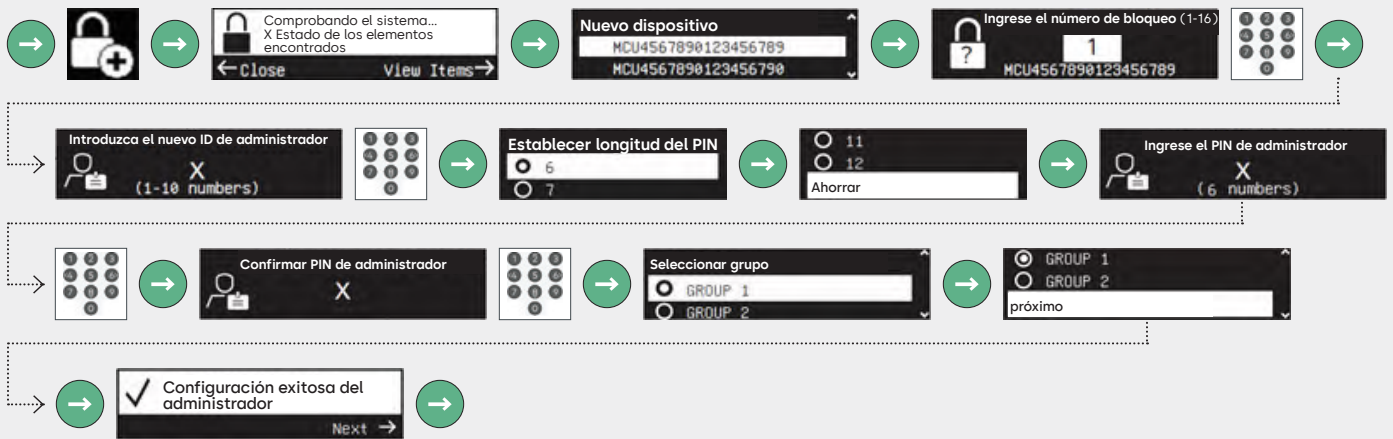

2 Agregar usuario

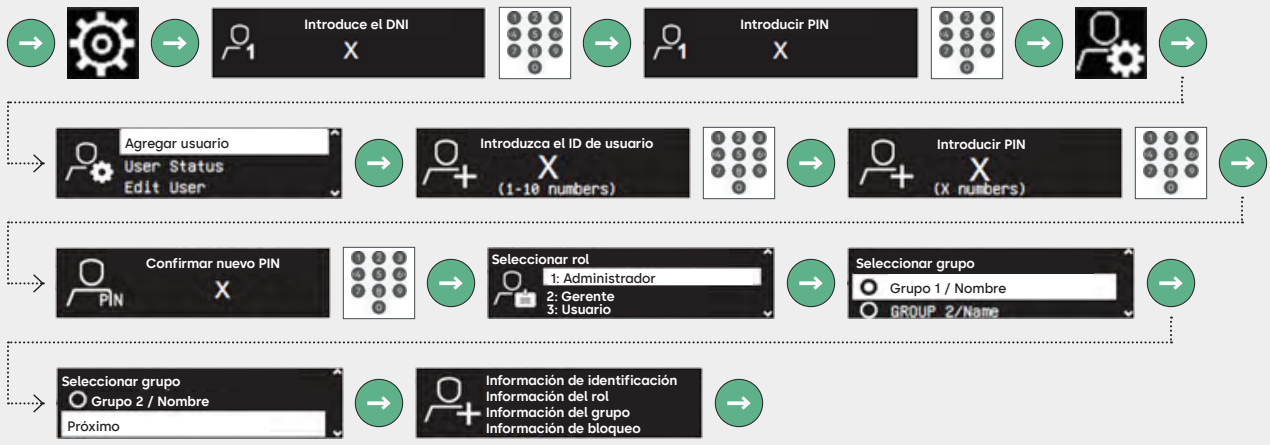

3 Ajustar tiempo de retardo

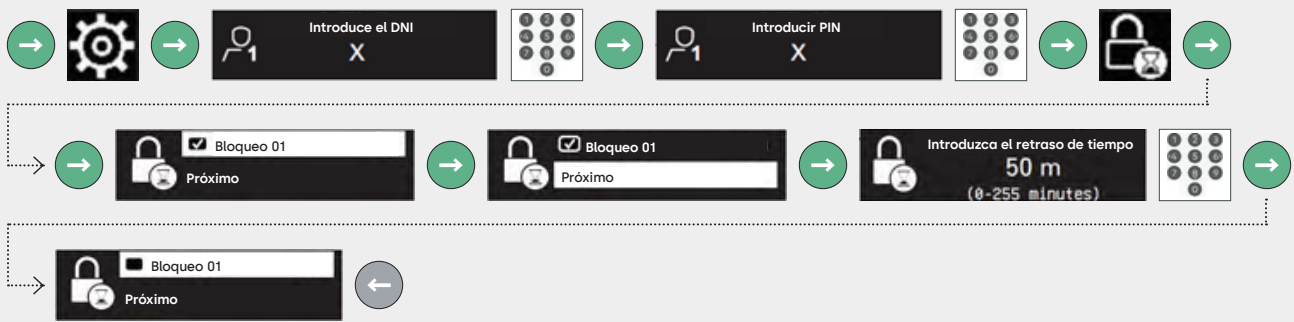

Teclado numérico Axessor Apexx - Funciones básicas

4 Cambiar PIN



5 Abrir cerradura

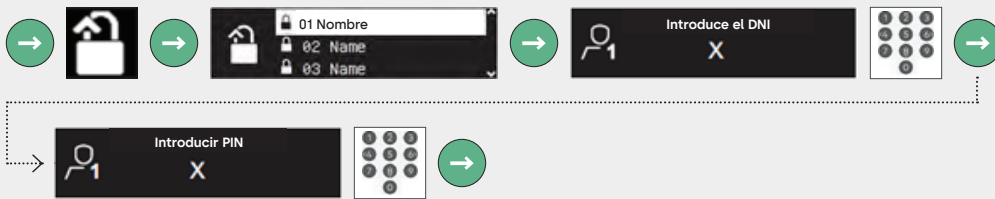

6 Menú de información del sistema

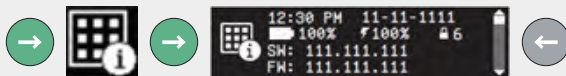

Instrucciones

Encontrará instrucciones detalladas en: www.dormakaba.us



GUÍAS DE INSTALACIÓN
Y USO DE AXESSOR
APEXX

¿Tiene alguna pregunta? Se la resolveremos con mucho gusto.

Póngase en contacto con nosotros: sales.safelocks.us@dormakaba.com

Clavier Axxessor Apexx

Guide de démarrage rapide

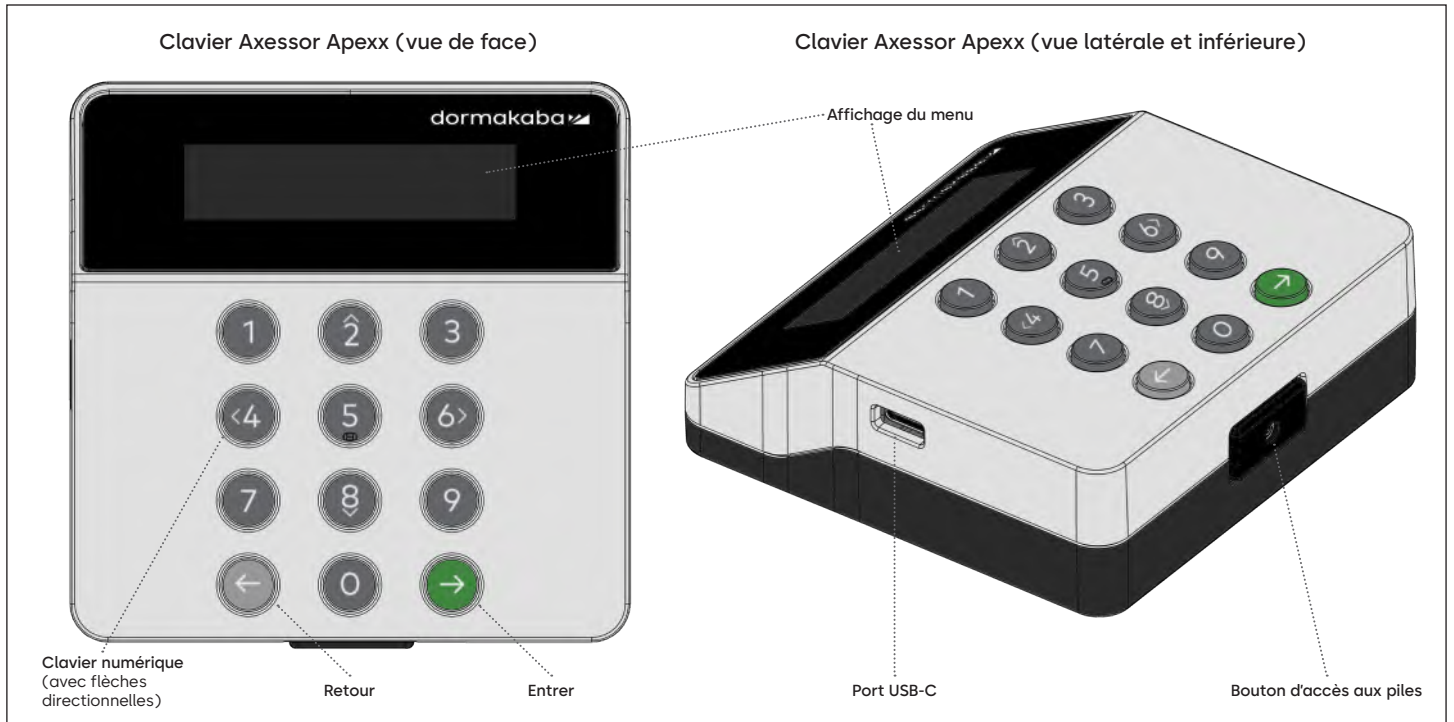

Modèles de perçage, ébavurage, taraudage

Clavier Axxessor Apexx

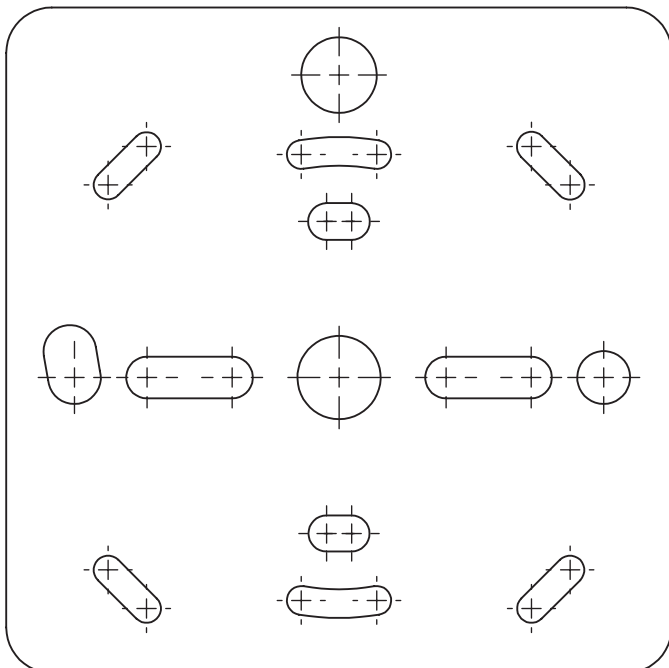

Serrure de la série Apexx

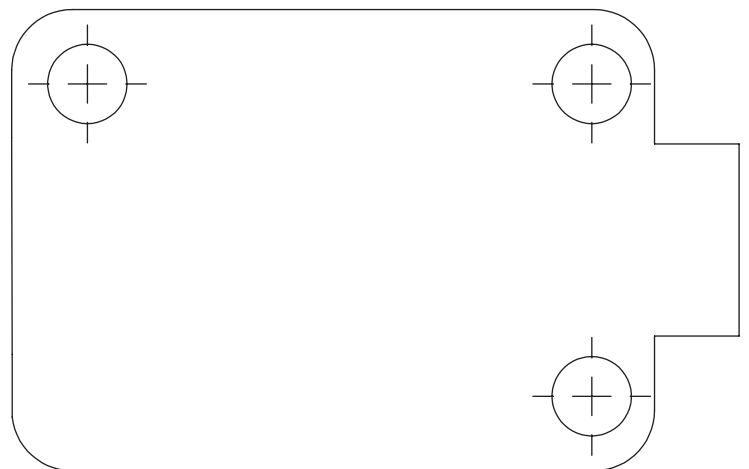

Installation du clavier Apexx et de la serrure de la série Apexx

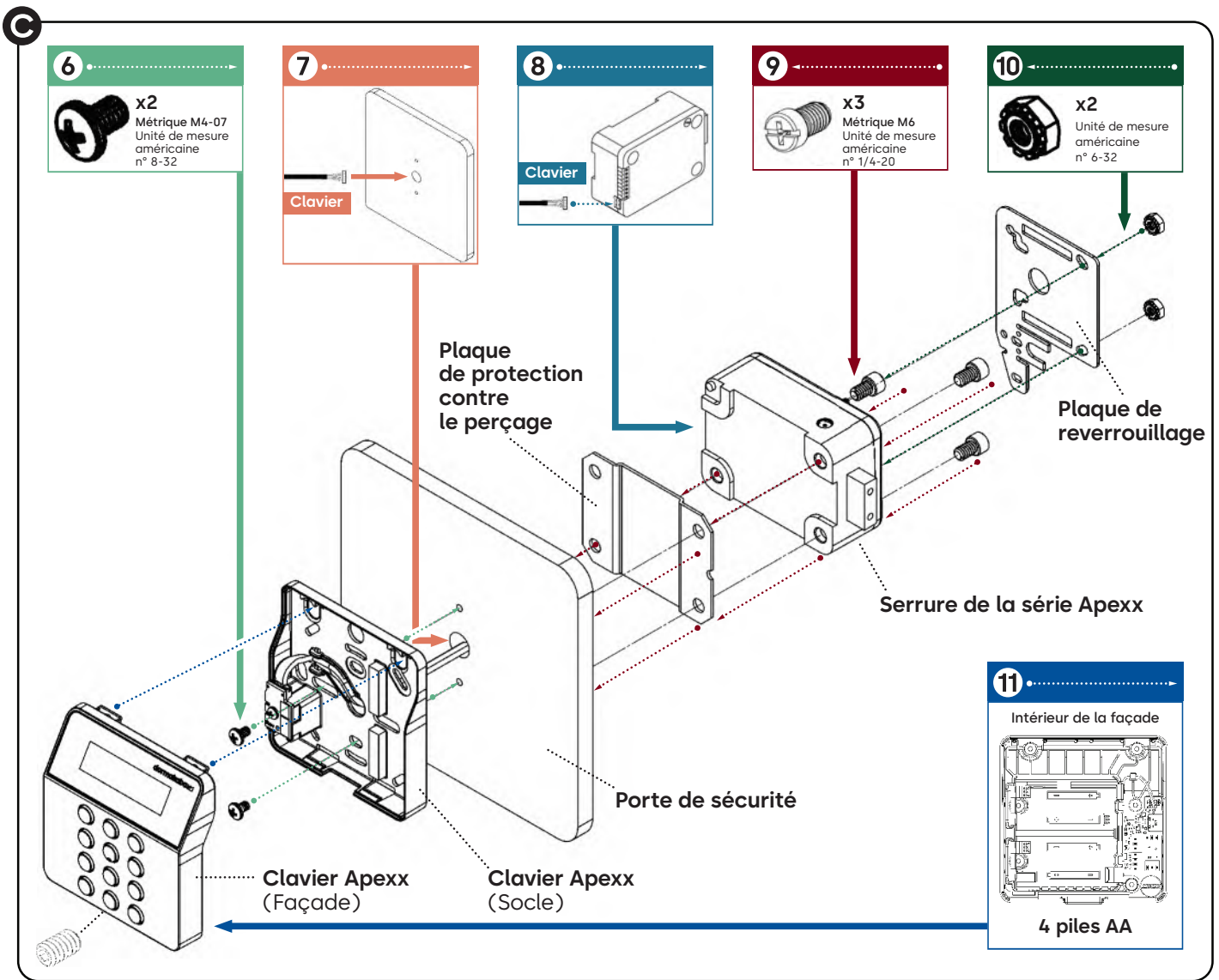
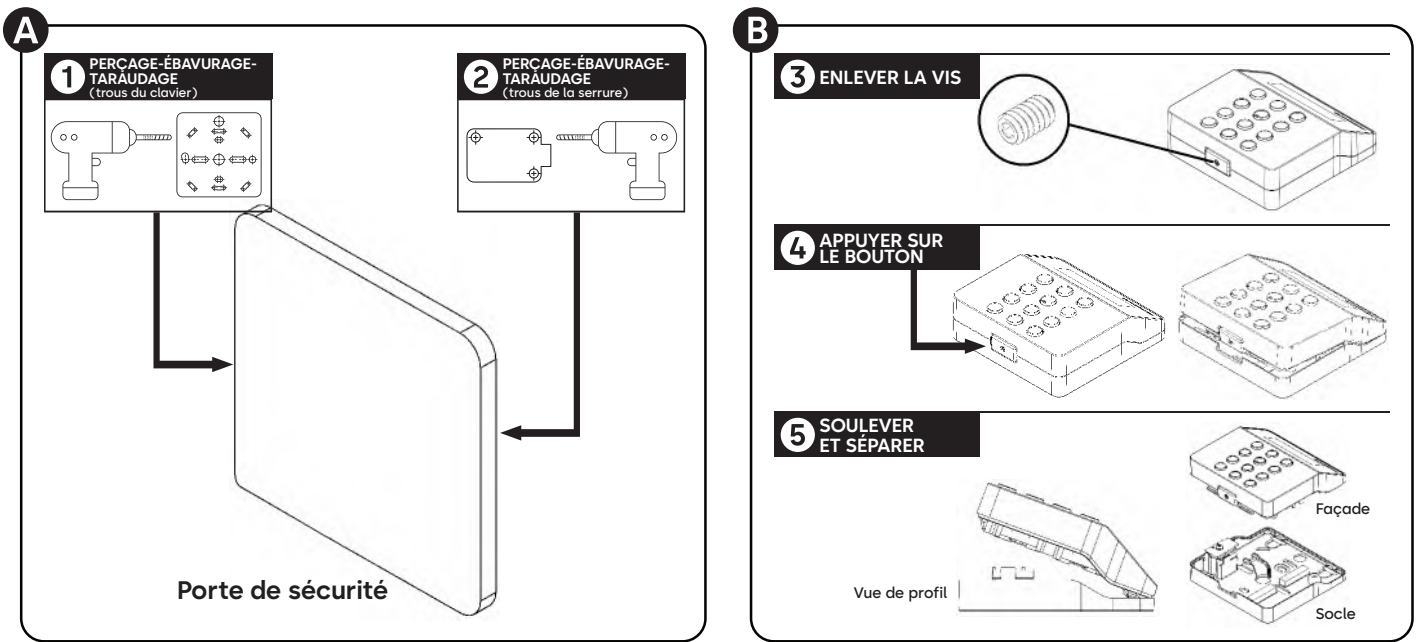

1 Installer la première serrure et créer un utilisateur administrateur

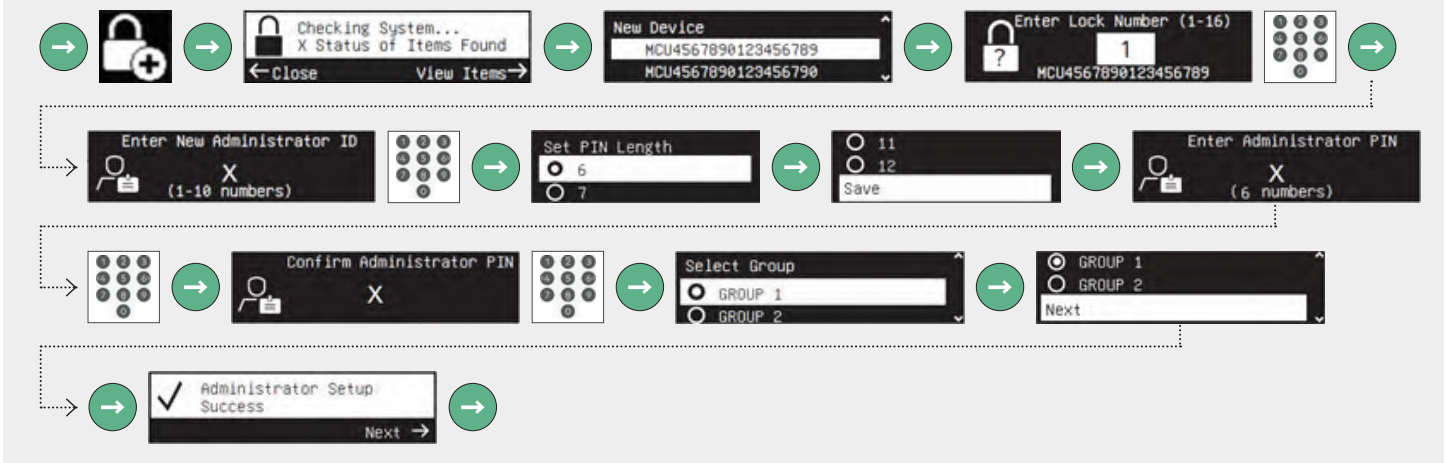

2 Ajouter un utilisateur

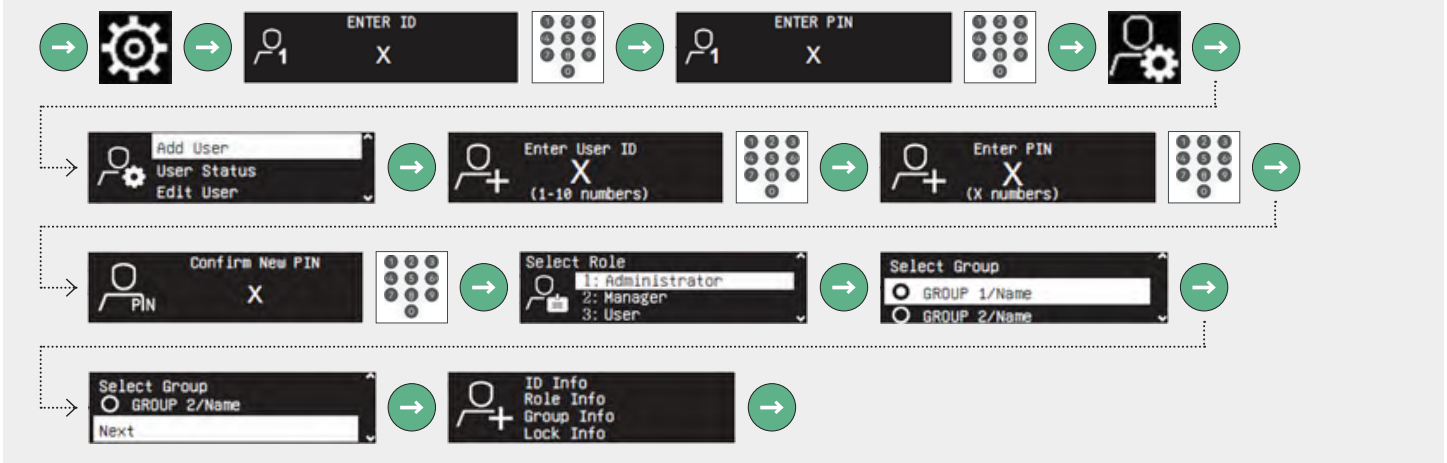

3 Régler la temporisation

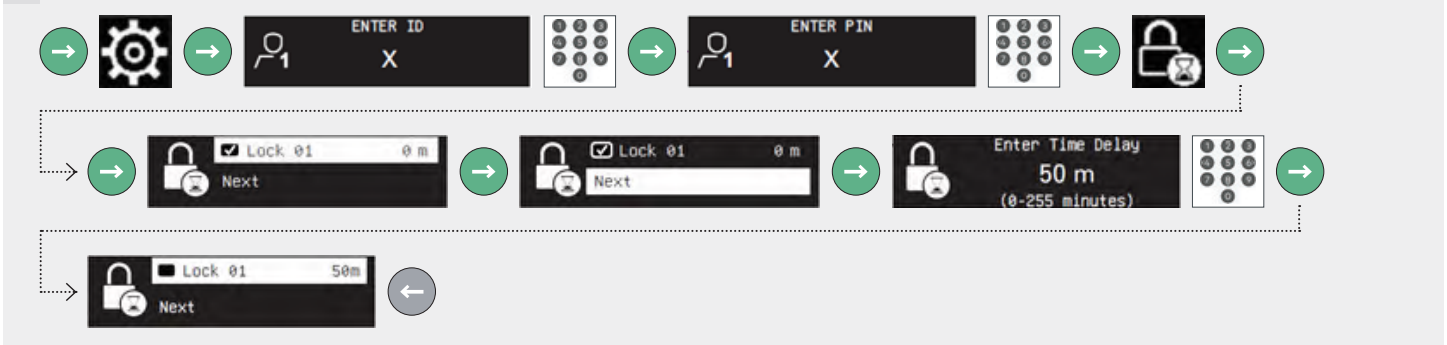

Clavier Axessor Apexx – Fonctions de base

4 Modifier le code PIN



5 Ouvrir la serrure

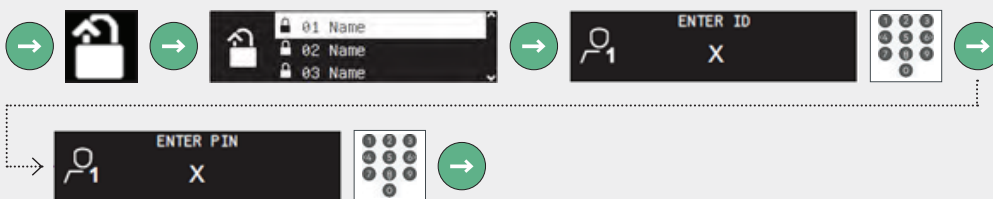

6 Menu Infos système

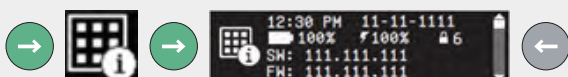

Instructions

Pour des instructions détaillées, consultez le site suivant : www.dormakaba.us



GUIDES D'INSTALLATION
ET D'UTILISATION
D'AXESSOR APEXX

Avez-vous des questions ? Nous nous ferons un plaisir de vous conseiller.

Contactez-nous : sales.safelocks.us@dormakaba.com

Axessor Apexx-Tastatur

Schnellstartanleitung

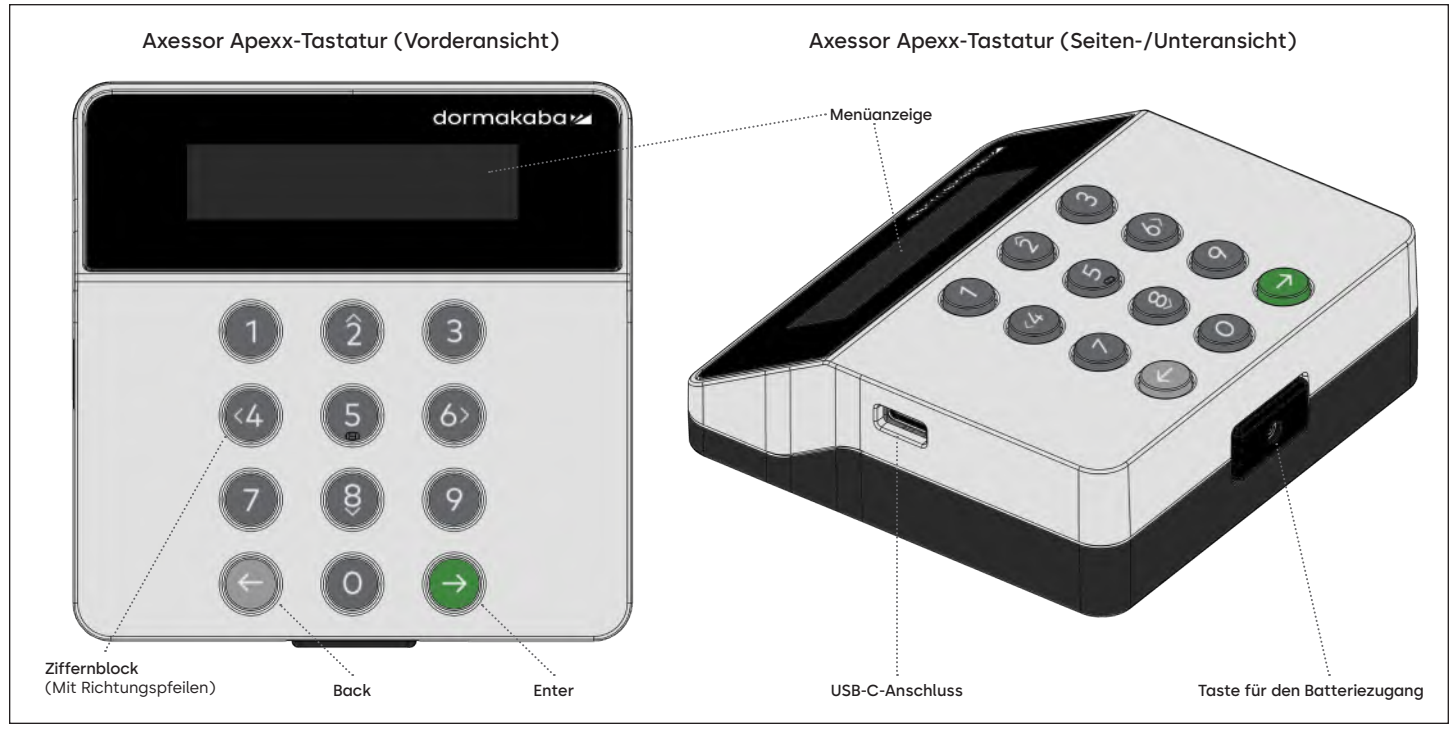

Bohr-Entgrat-Gewindeschneideschablonen

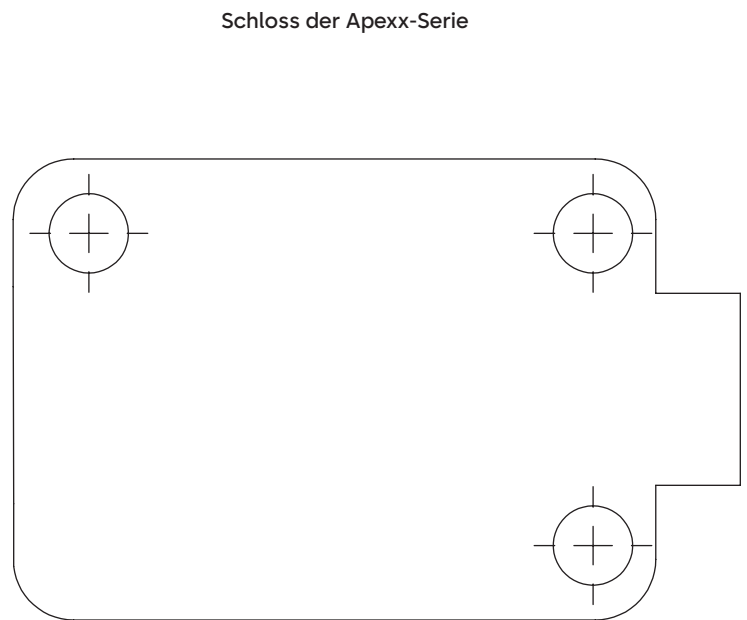
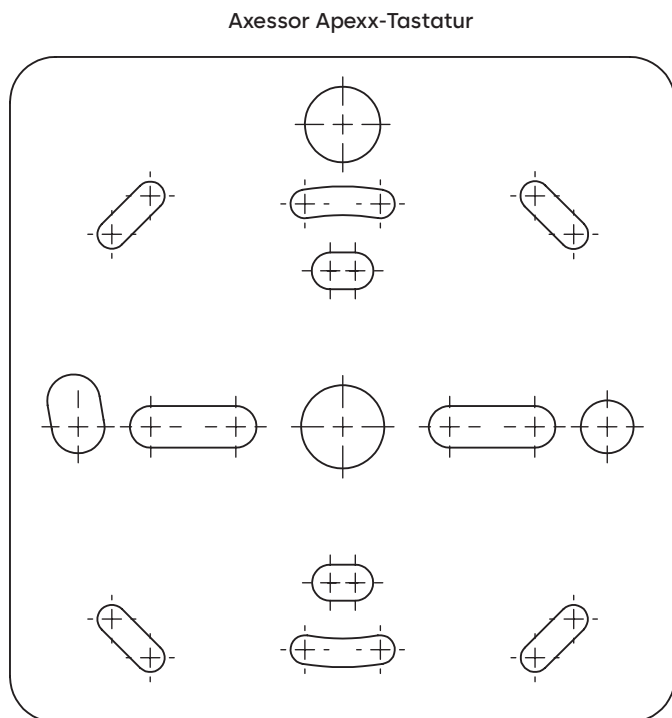

Axessor Apexx-Tastatur und Schloss der Apexx-Serie – Montage

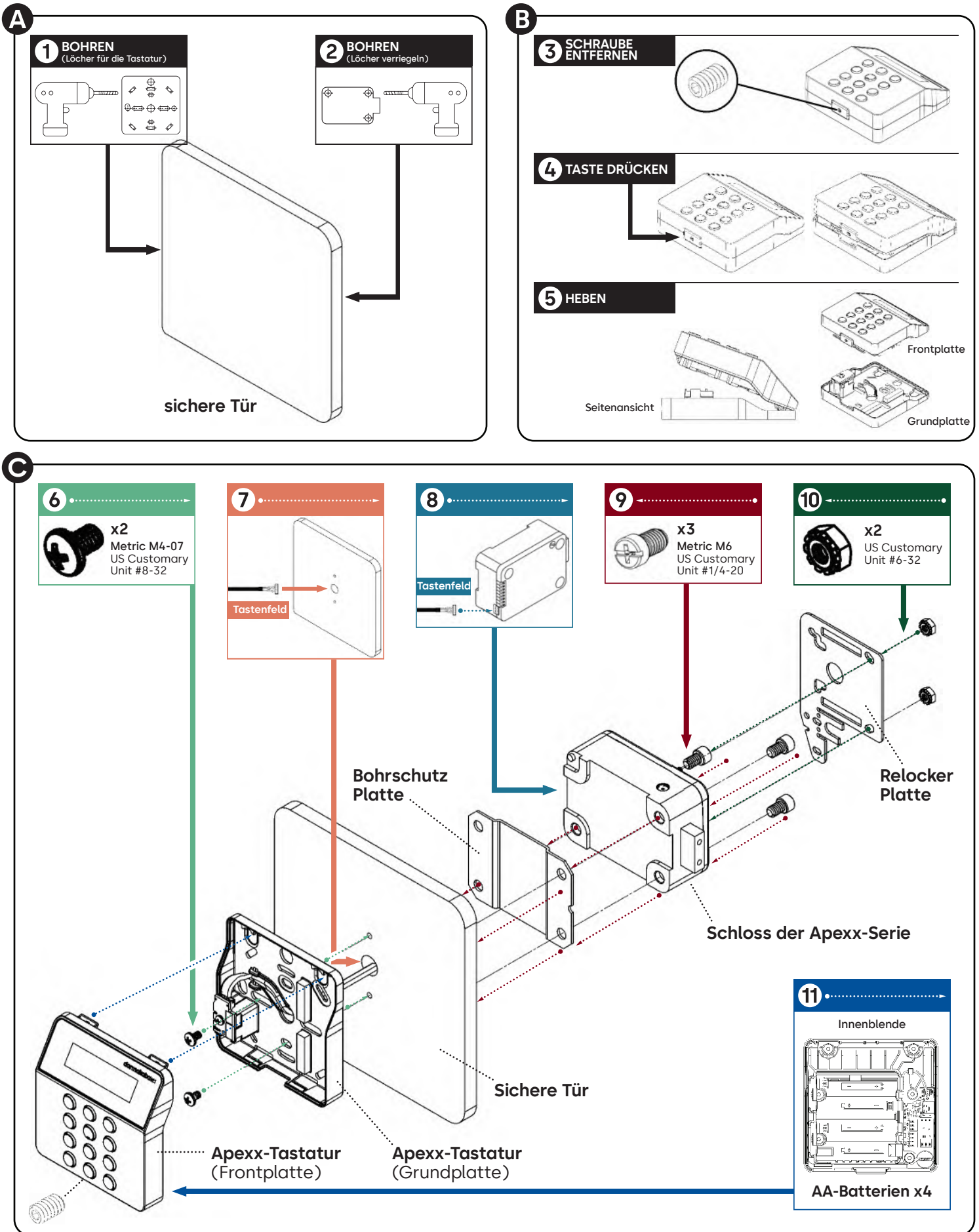

1 Erstes Schloss installieren und Admin-Benutzer erstellen

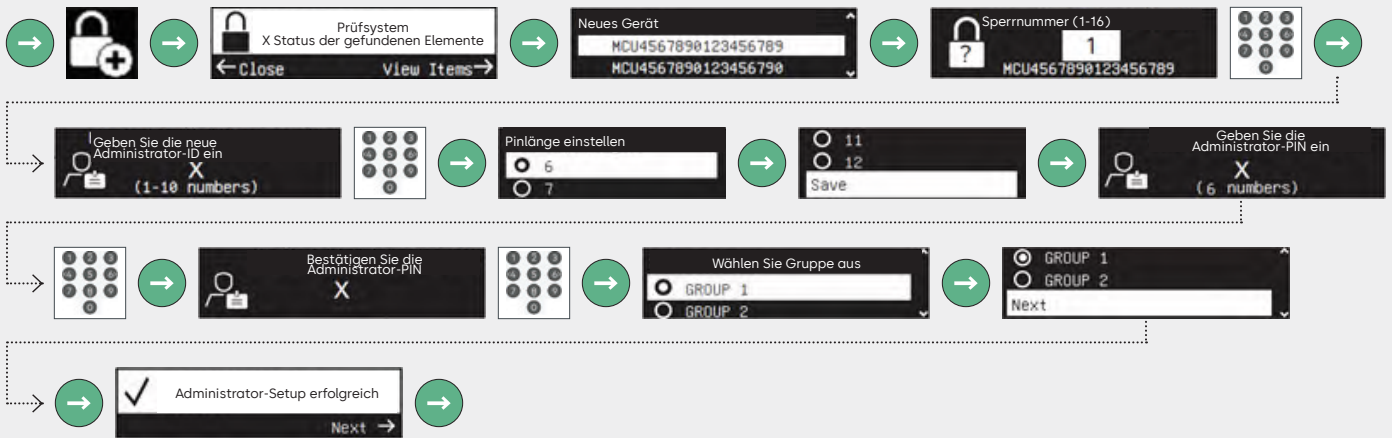

2 Benutzer hinzufügen

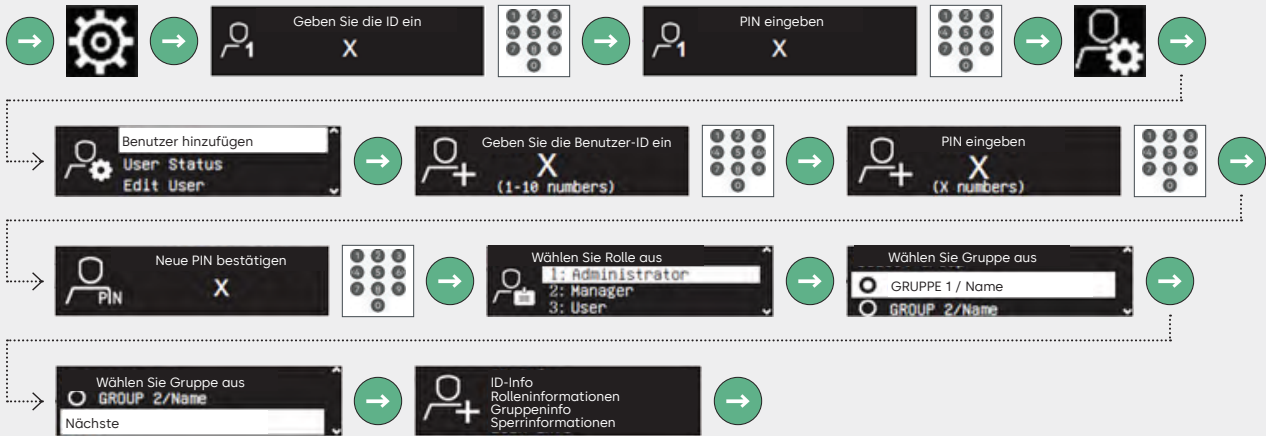

3 Zeitverzögerung festlegen

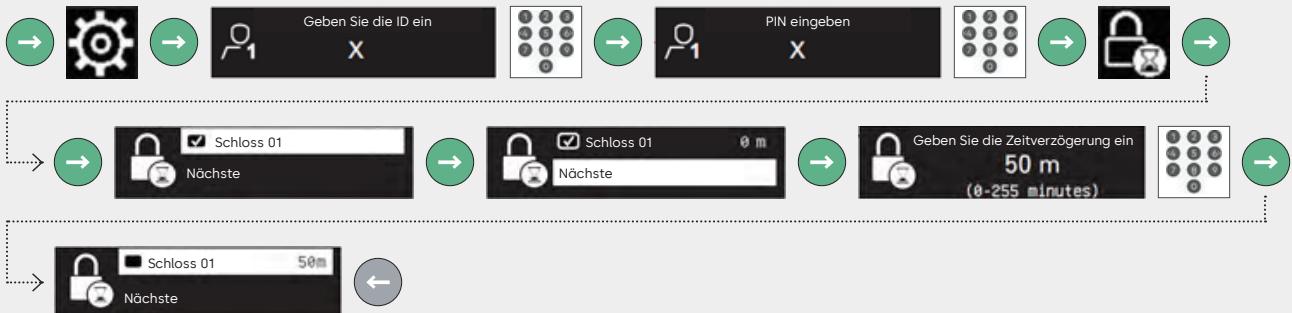

Axessor Apexx-Tastatur – Basisfunktionen

4 PIN ändern



5 Schloss öffnen

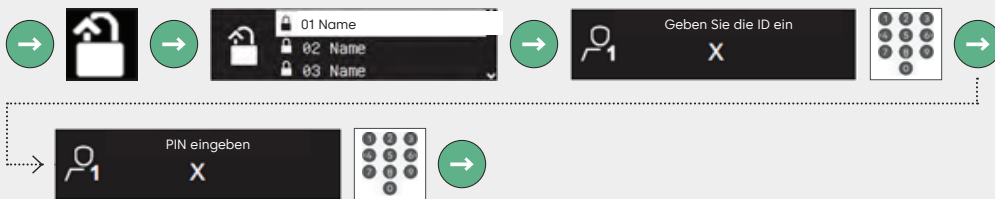

6 Menü Systeminformationen



Anleitung

Eine detaillierte Anleitung finden Sie unter: www.dormakaba.us



AXESSOR APEXX-
MONTAGE- UND
BEDIENUNGSANLEITUNGEN

Haben Sie Fragen? Wir helfen Ihnen gerne weiter.

Oder schreiben Sie uns eine E-Mail an safelocks.de@dormakaba.com

Tastierino Axessor Apexx

Guida all'avvio rapido

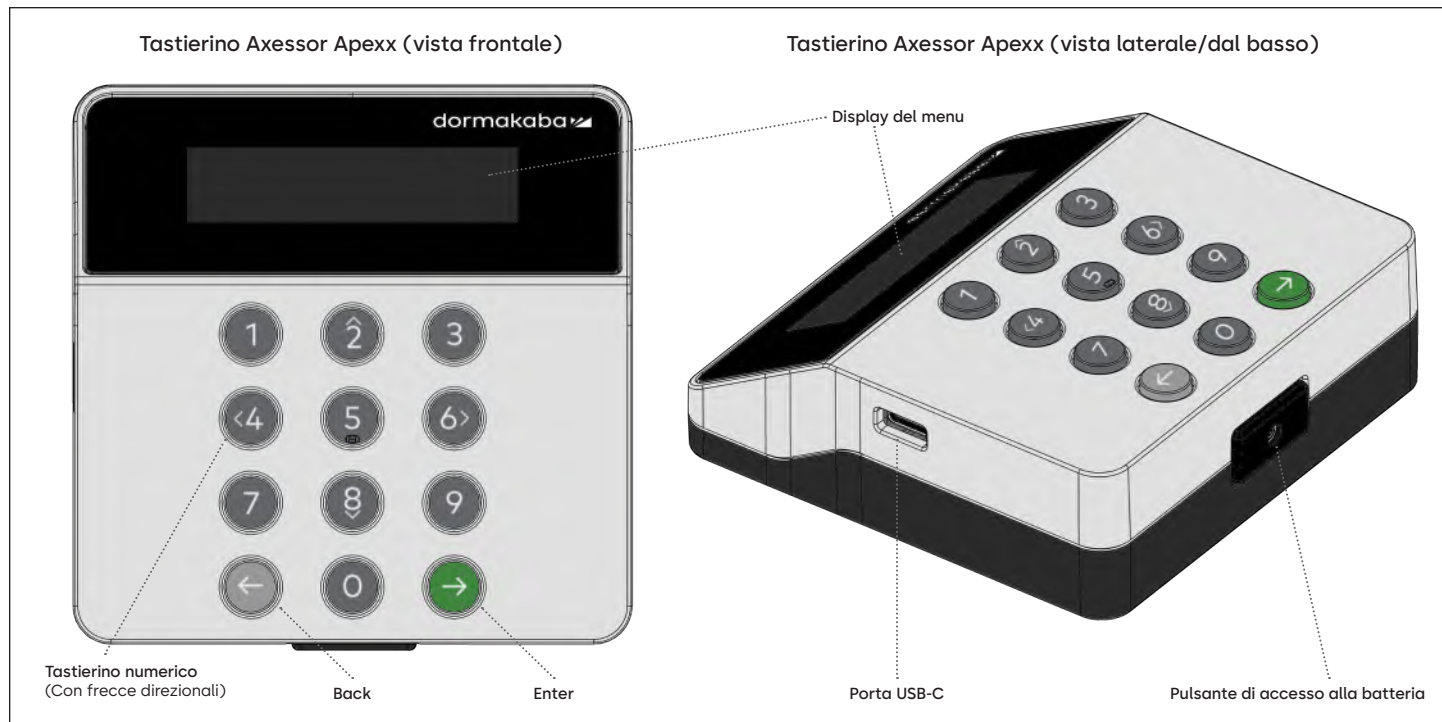

Modelli di foratura-sbavatura-trapano

Tastierino Axessor Apexx

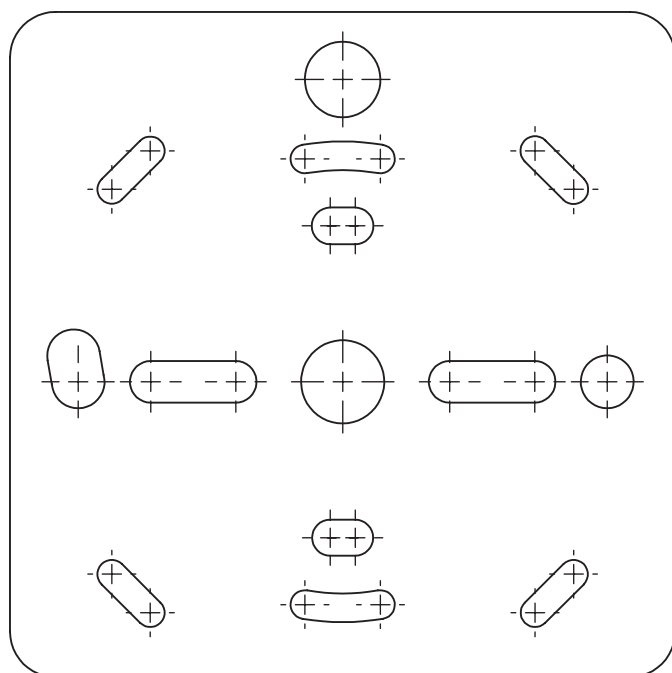

Serratura serie Apexx

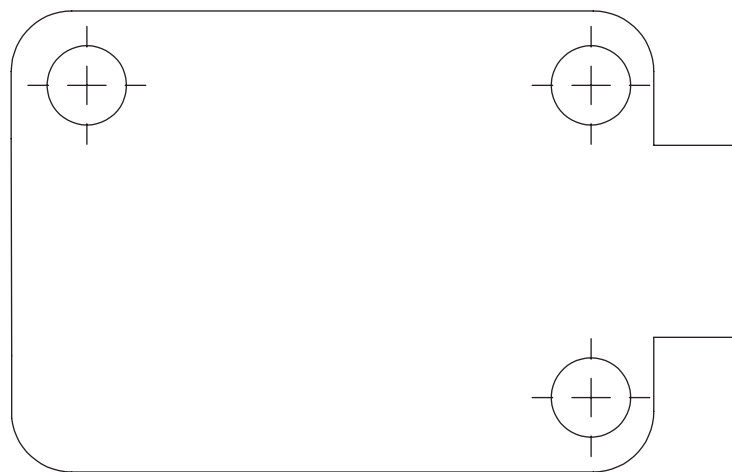

Installazione tastierino Axessor Apexx e serratura della serie Apexx

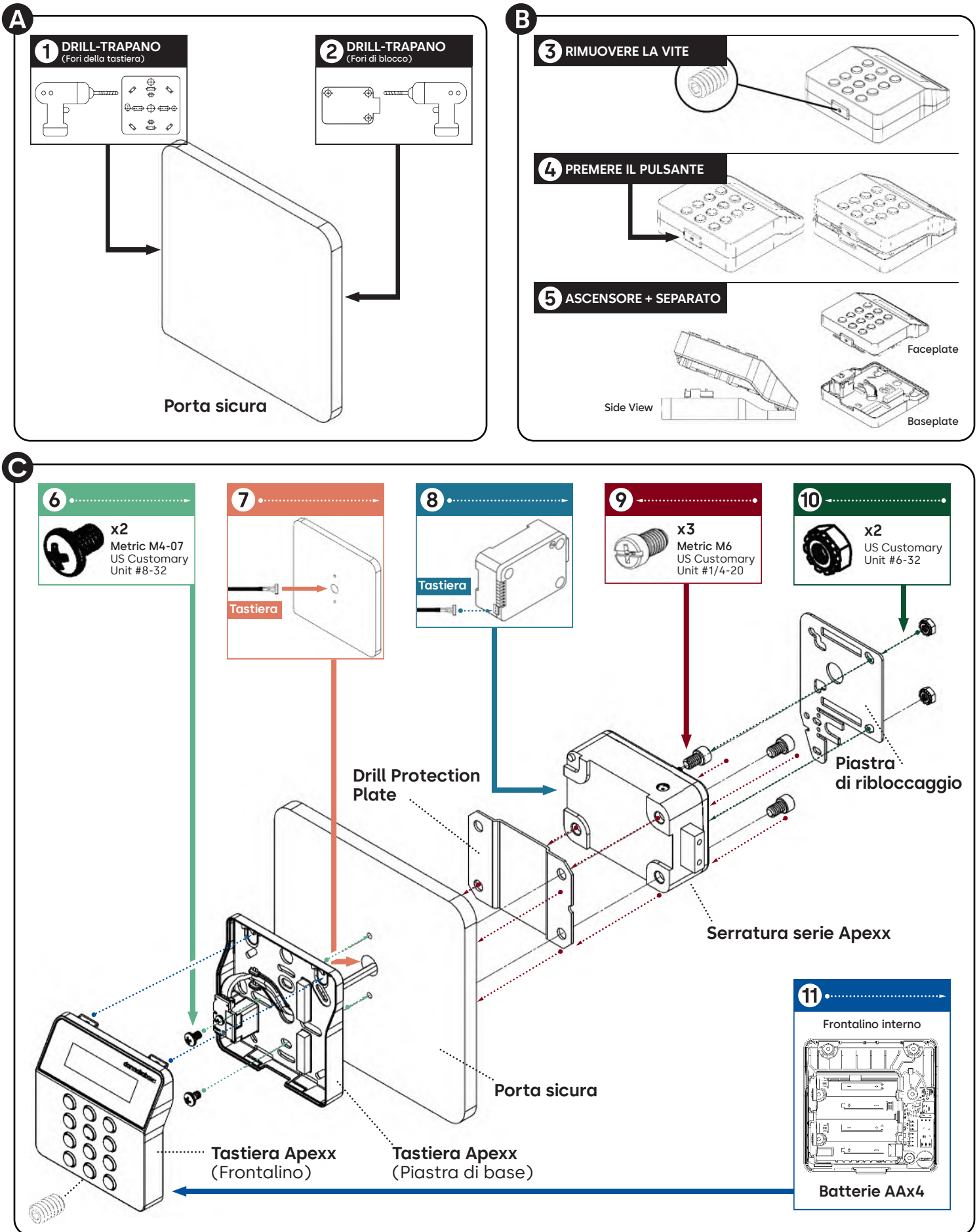

Tastierino Axessor Apexx: funzioni di base

1 Installare la prima serratura e creare l'utente amministratore

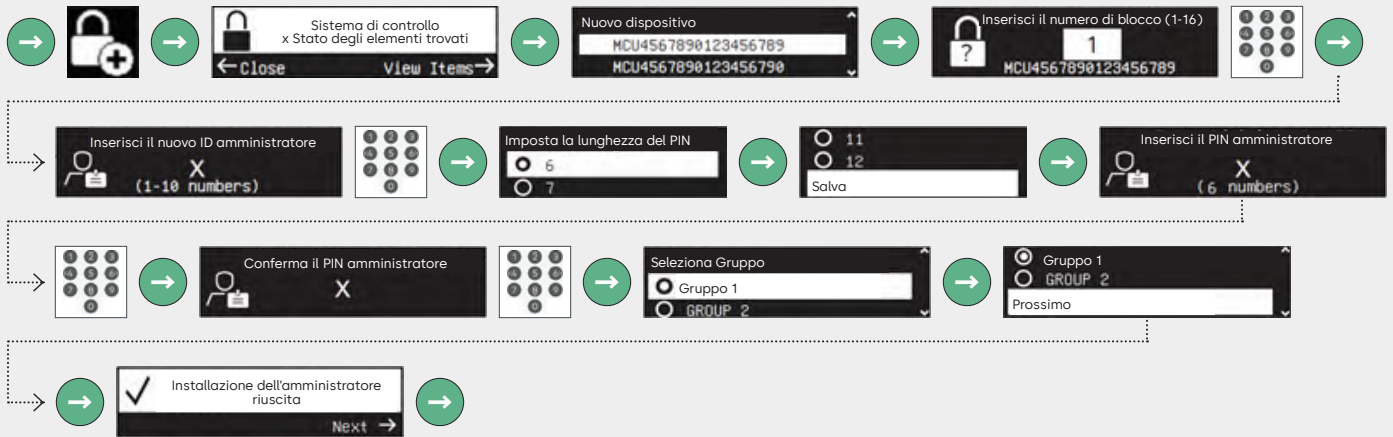

2 Aggiungi utente

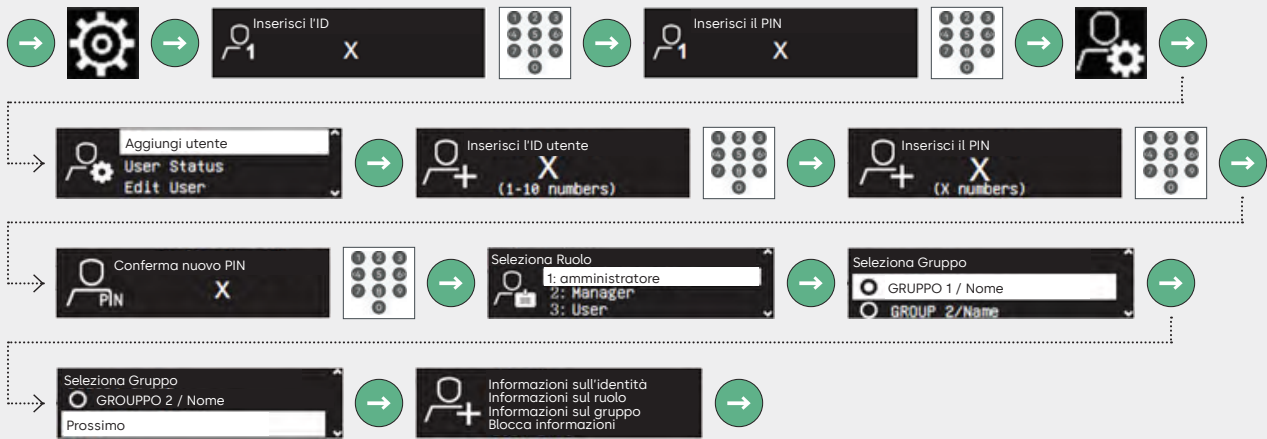

3 Imposta apertura ritardata

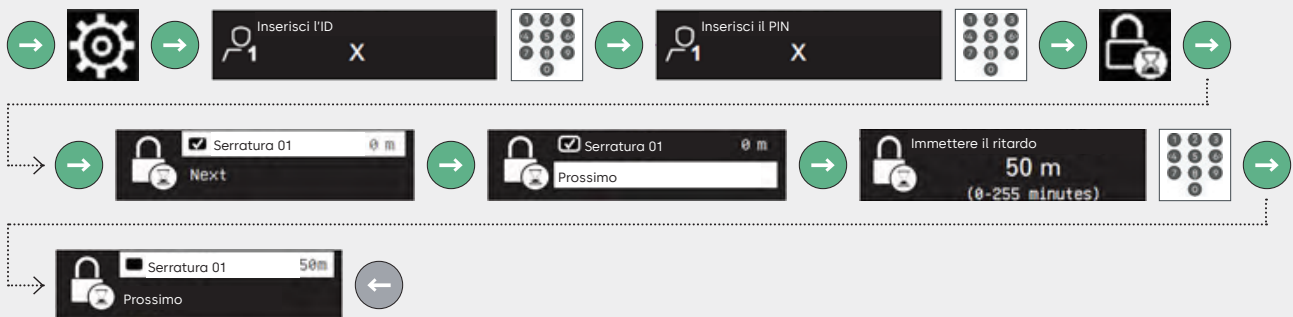

Tastierino Axessor Apexx: funzioni di base

4 Modifica PIN



5 Apertura della serratura

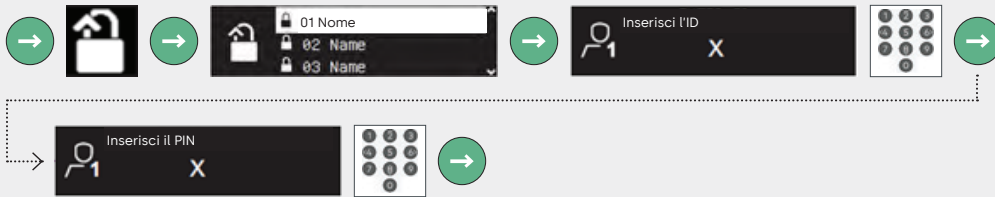

6 Menu informazioni sul sistema

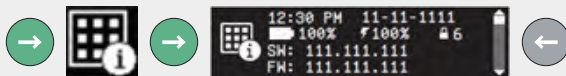

Istruzioni

Per istruzioni dettagliate, visitare il sito: www.dormakaba.us



GUIDE ALL'INSTALLAZIONE
E AL FUNZIONAMENTO DI
AXESSOR APEXX

Hai altre domande? Saremo lieti di consigliarti.

Contattaci: sales.safelocks.us@dormakaba.com

Teclado Axessor Apexx

Guia de início rápido

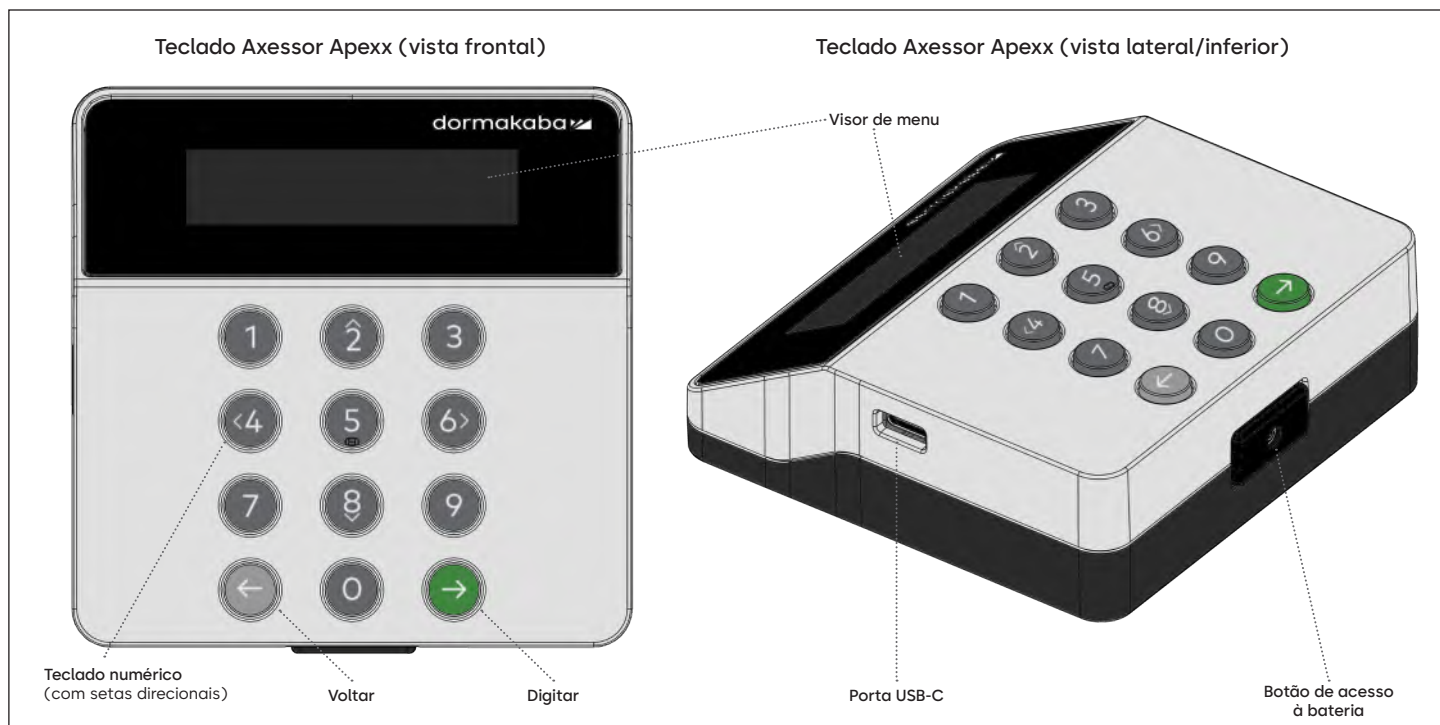

Modelos de perfuração, eliminação de rebarba e abertura

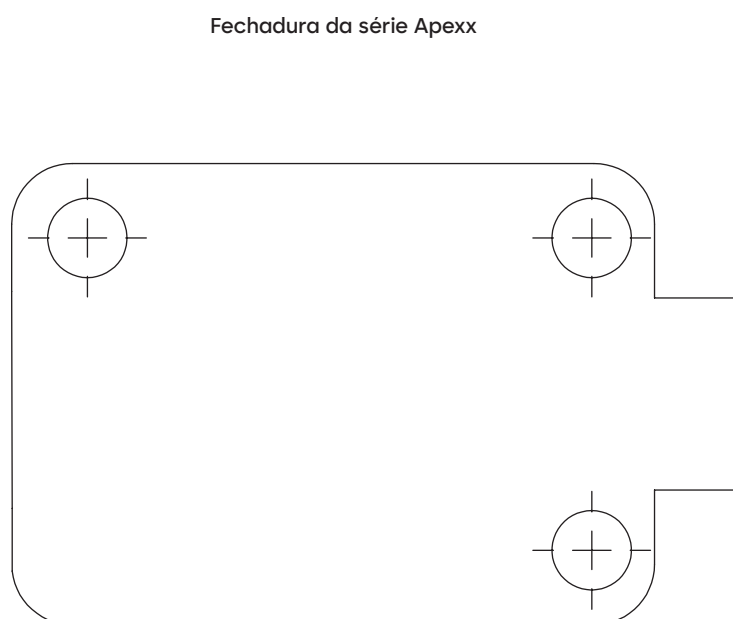
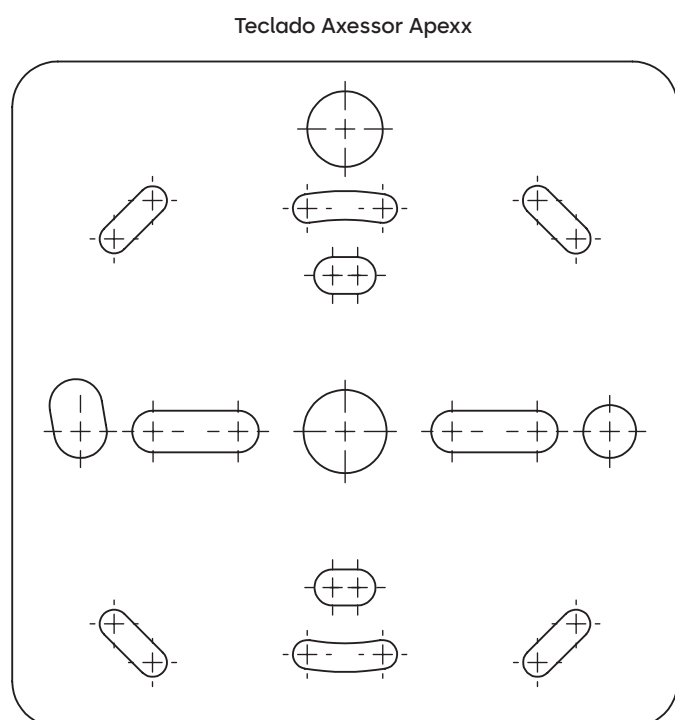

Instalação do teclado Apexx e da fechadura da série Apexx

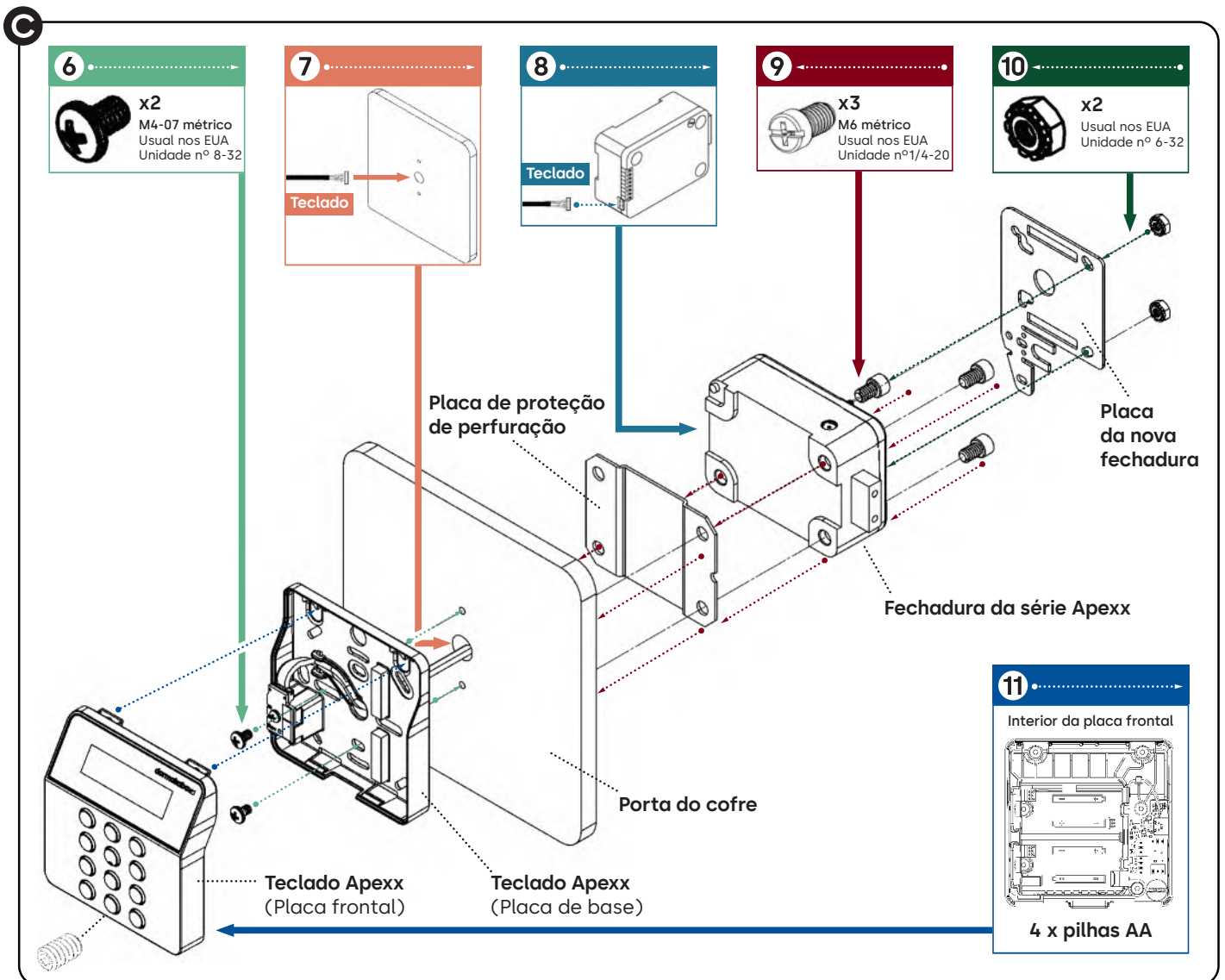
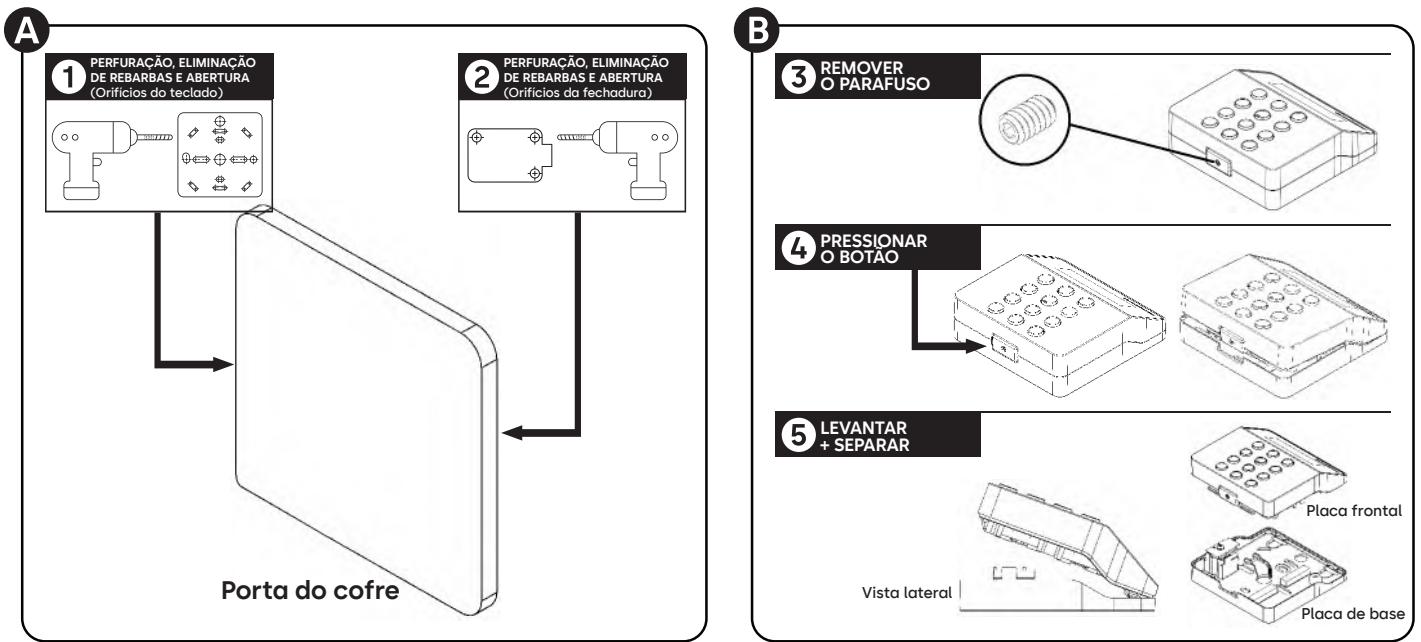

Teclado Axessor Apexx – funções básicas

1 Instalar a primeira fechadura e criar o usuário administrador

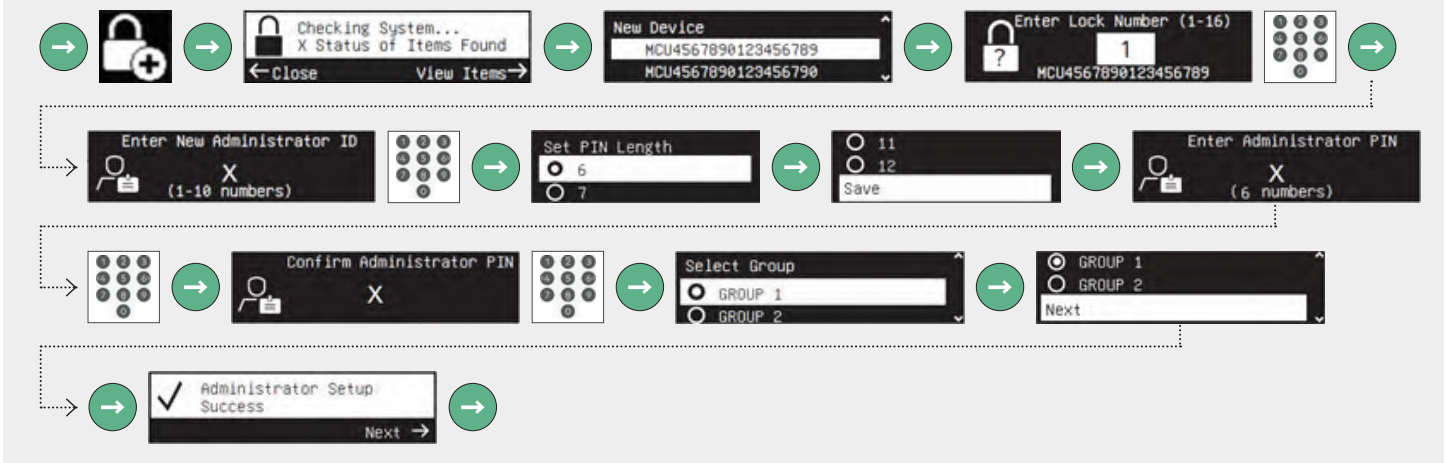

2 Adicionar usuário

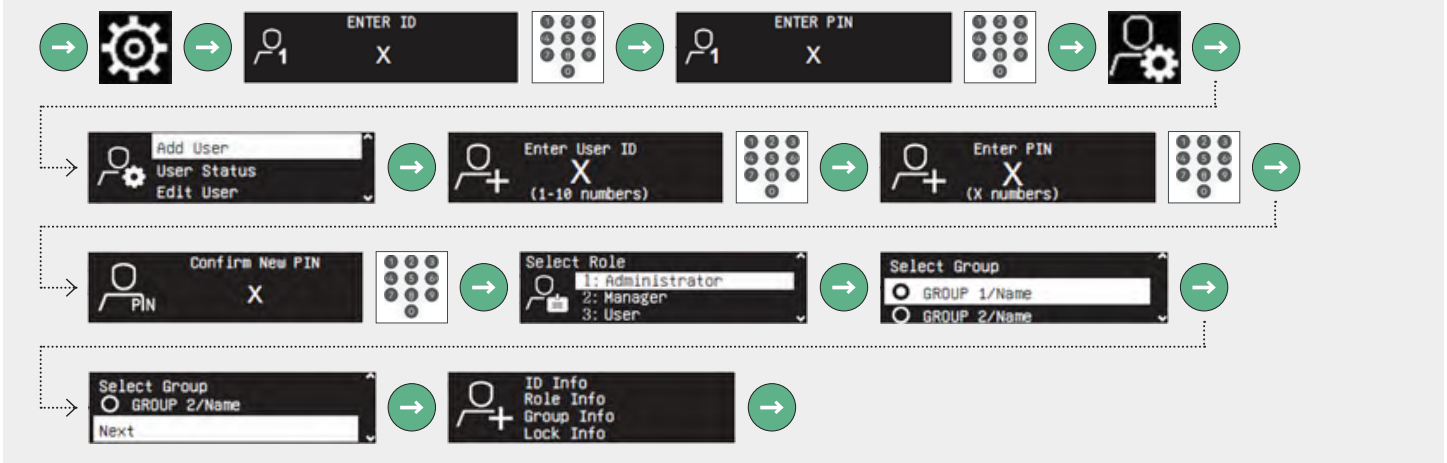

3 Definir o tempo de retardo

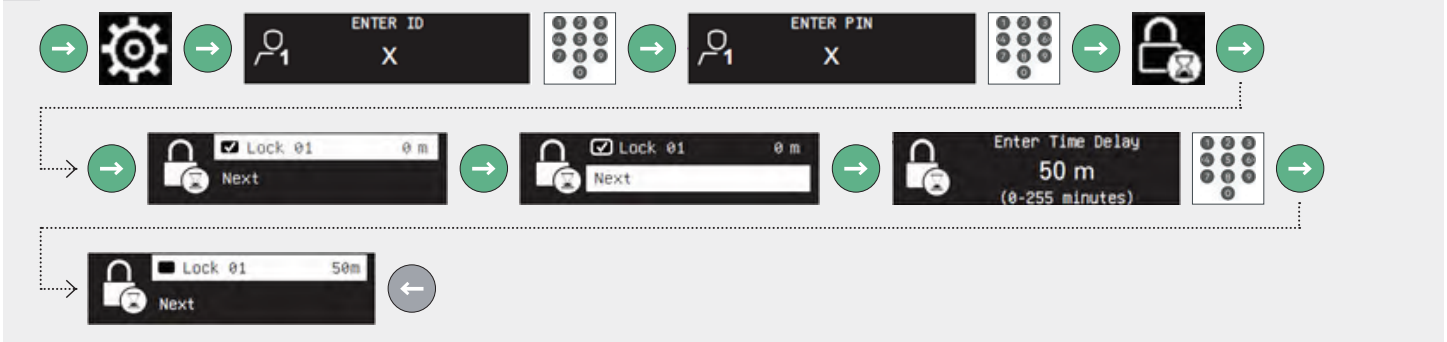

Teclado Axessor Apexx – funções básicas

4 Alterar PIN

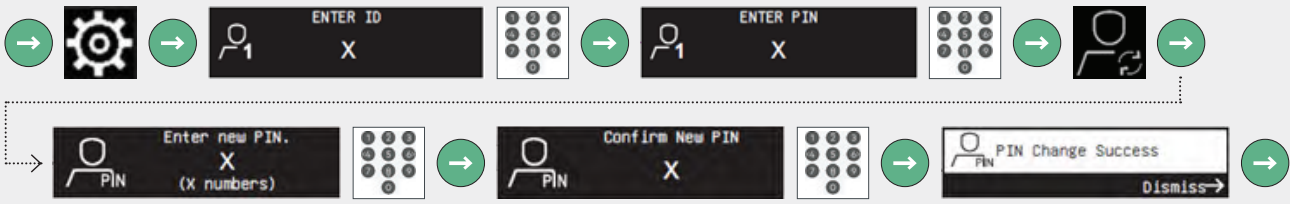

5 Abrir fechad.

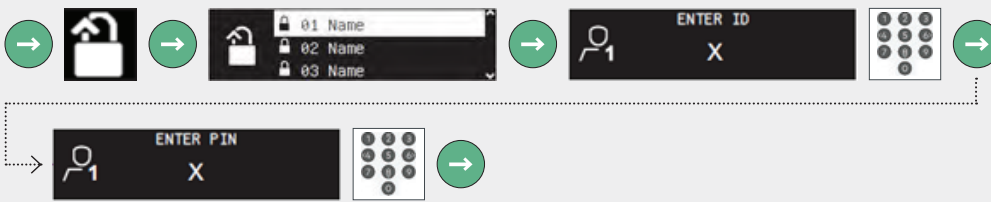

6 Menu Informações do sistema



Instruções

Para obter instruções detalhadas, acesse: www.dormakaba.us



GUIAS DE INSTALAÇÃO
E OPERAÇÃO DO
AXESSOR APEXX

Alguma dúvida? Teremos prazer em orientá-lo.

Entre em contato conosco: sales.safelocks.us@dormakaba.com

Klawiatura Axessor Apexx

Skrócona instrukcja obsługi

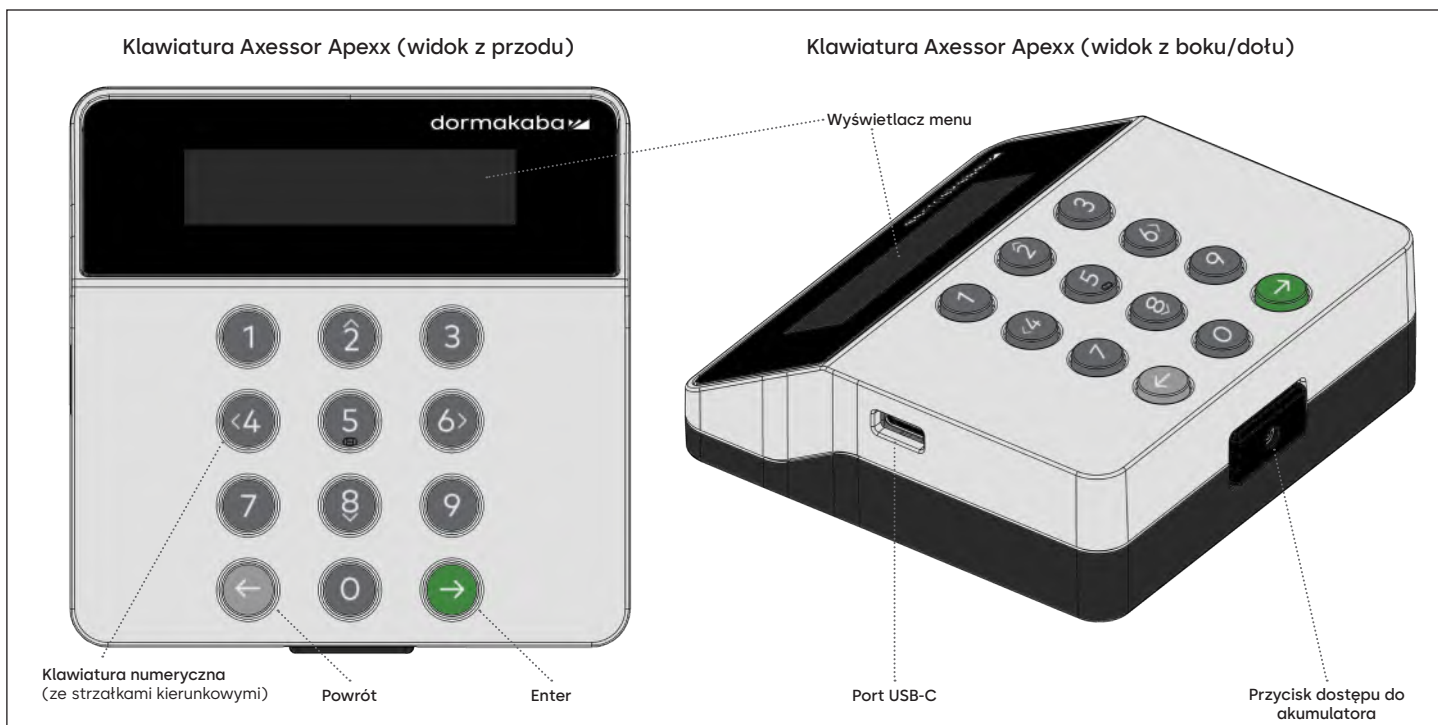

Szablony Wiercenie-Wygładzanie-Gwintowanie

Klawiatura Axessor Apexx

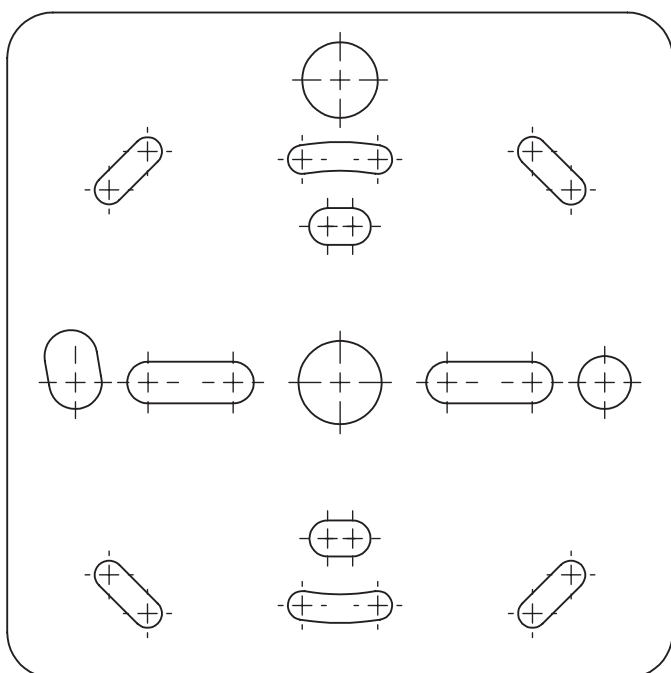

Zamek z serii Apexx

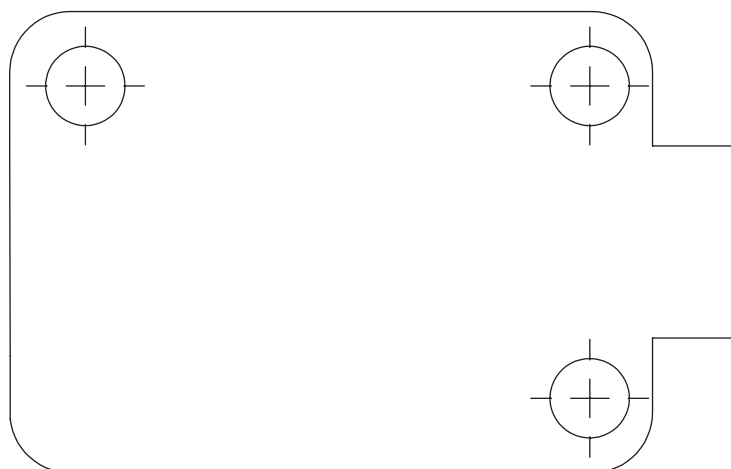

Instalacja klawiatury Axessor Apexx i zamka z serii Apexx

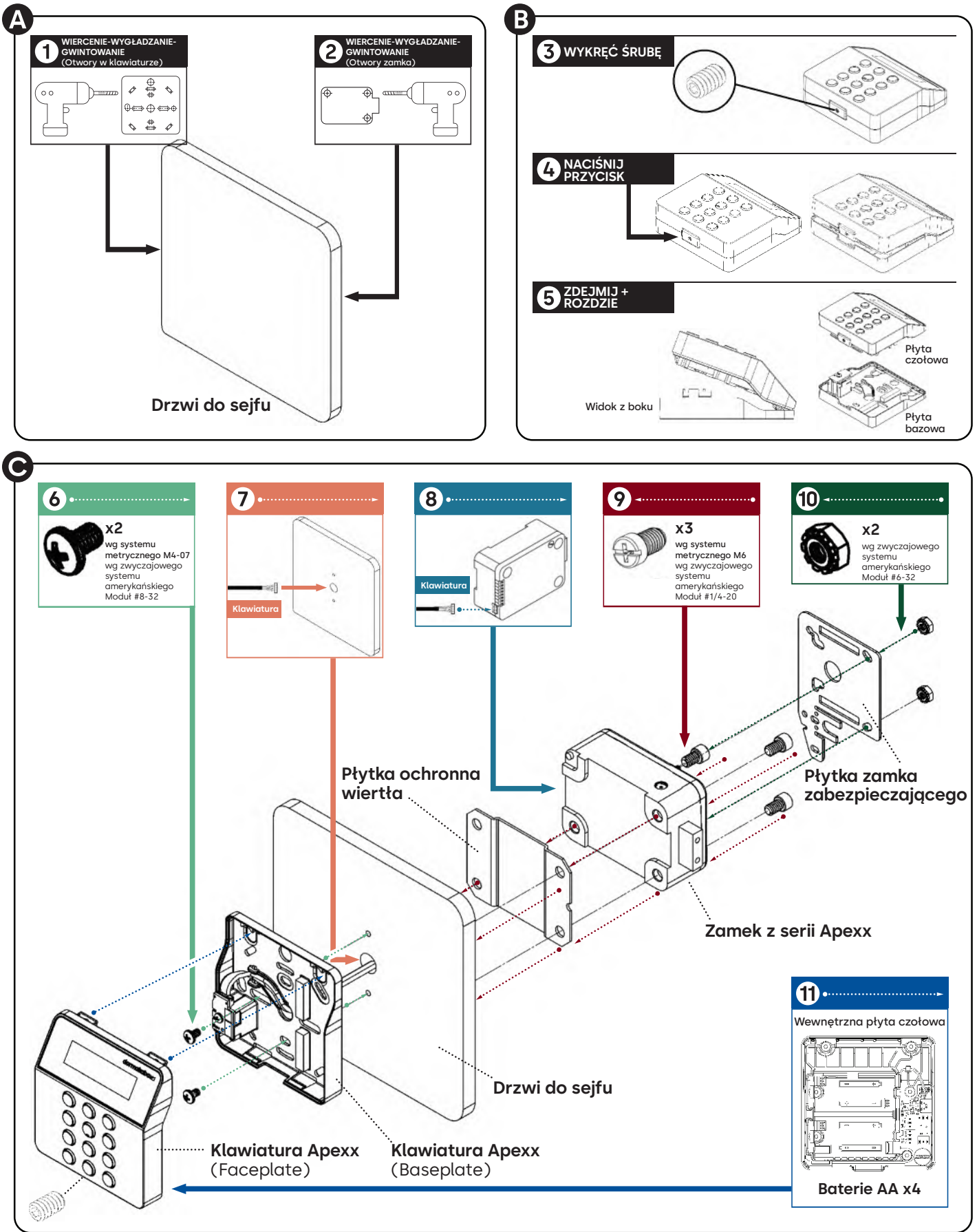

Klawiatura Axessor Apexx - podstawowe funkcje

1 Zainstaluj pierwszy zamek i utwórz użytkownika administratora

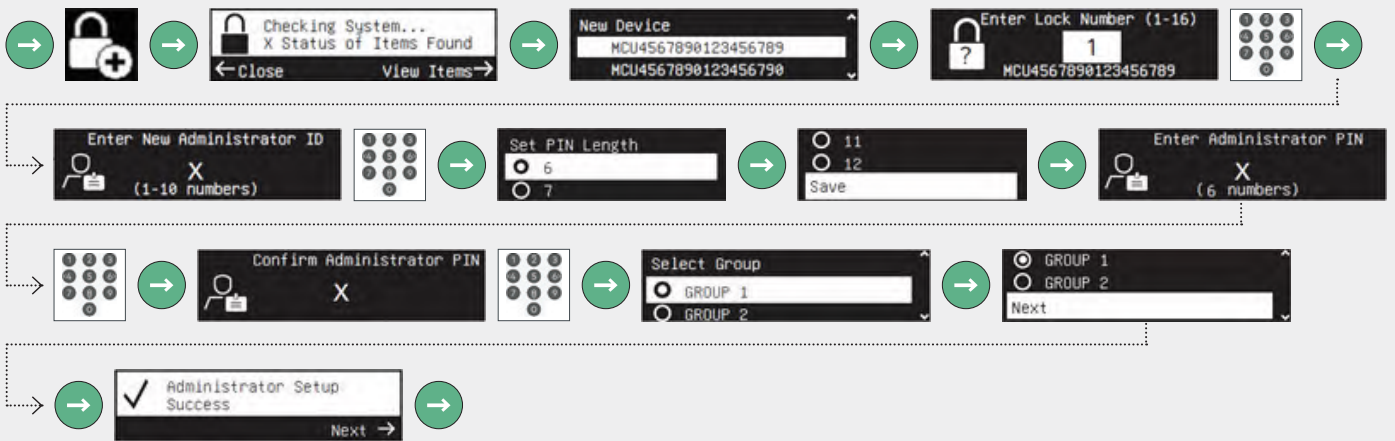

2 Dodaj użytkownika

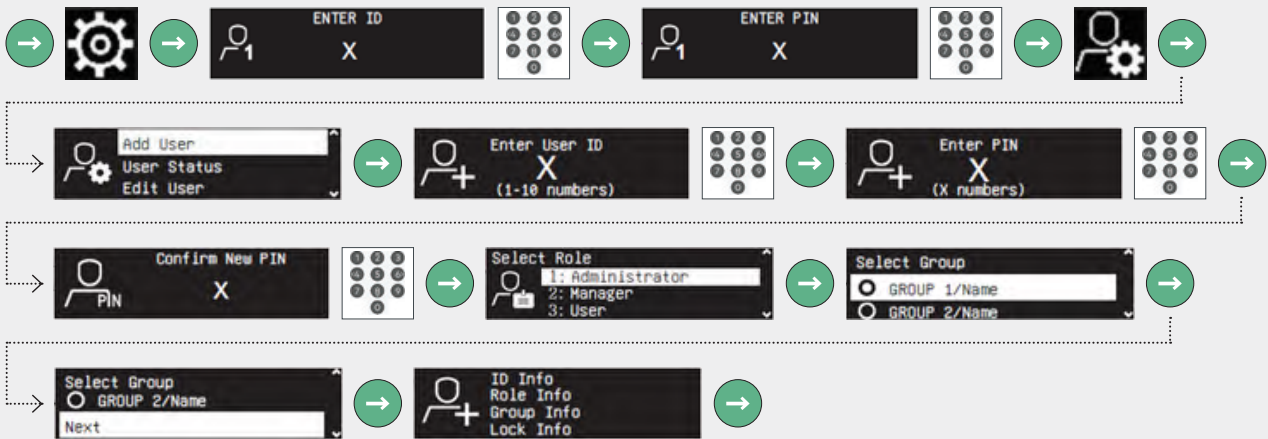

3 Ustawianie opóźnienia czasowego

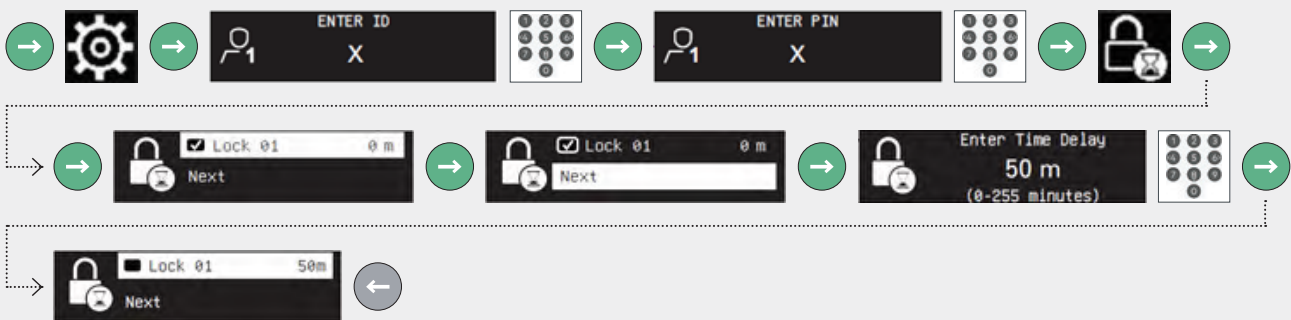

Klawiatura Axessor Apexx - podstawowe funkcje

4 Zmień kod PIN

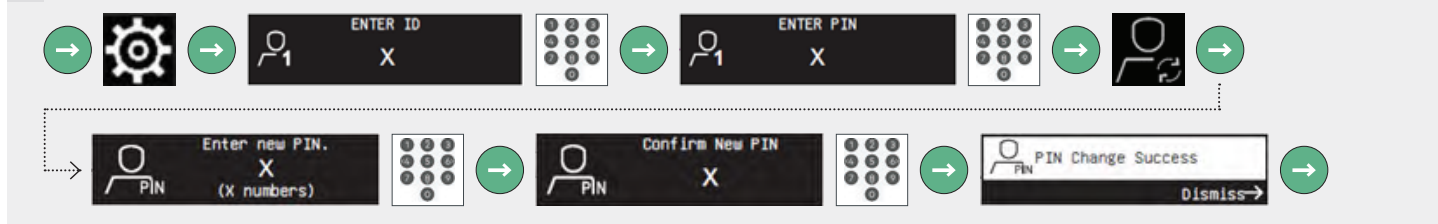

5 Otwórz zamek



6 Menu informacji o systemie

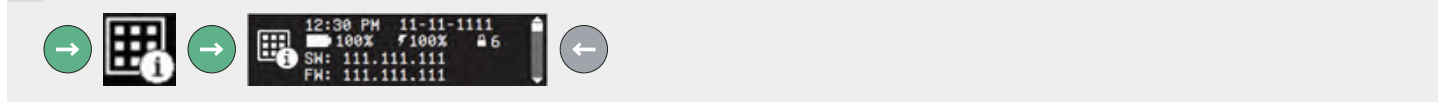

Instrukcje

Szczegółowe instrukcje można znaleźć na stronie: www.dormakaba.us



INSTRUKCJE
INSTALACJI I OBSŁUGI
AXESSOR APEXX

Jakieś pytania? Chętnie doradzimy.

Kontakt: sales.safelocks.us@dormakaba.com