

UK CA	dormakaba Deutschland GmbH Postfach 4009 58247 Ennepetal EN 1154:1996/A1:2002/AC:2006	22
	1121 UK-AD7931 DOP_0180_UKCA	1 1 1 4 8 3

CE	dormakaba Deutschland GmbH Postfach 4009 58247 Ennepetal EN 1154:1996/A1:2002/AC:2006	20
	0432-CPR-00026-33 DOP_0180	1 1 1 4 8 3

Änderungen vorbehalten
Subject to change without notice

NOTE: DC function does not fulfill requirements of EN1154 in parallel arm mounting.

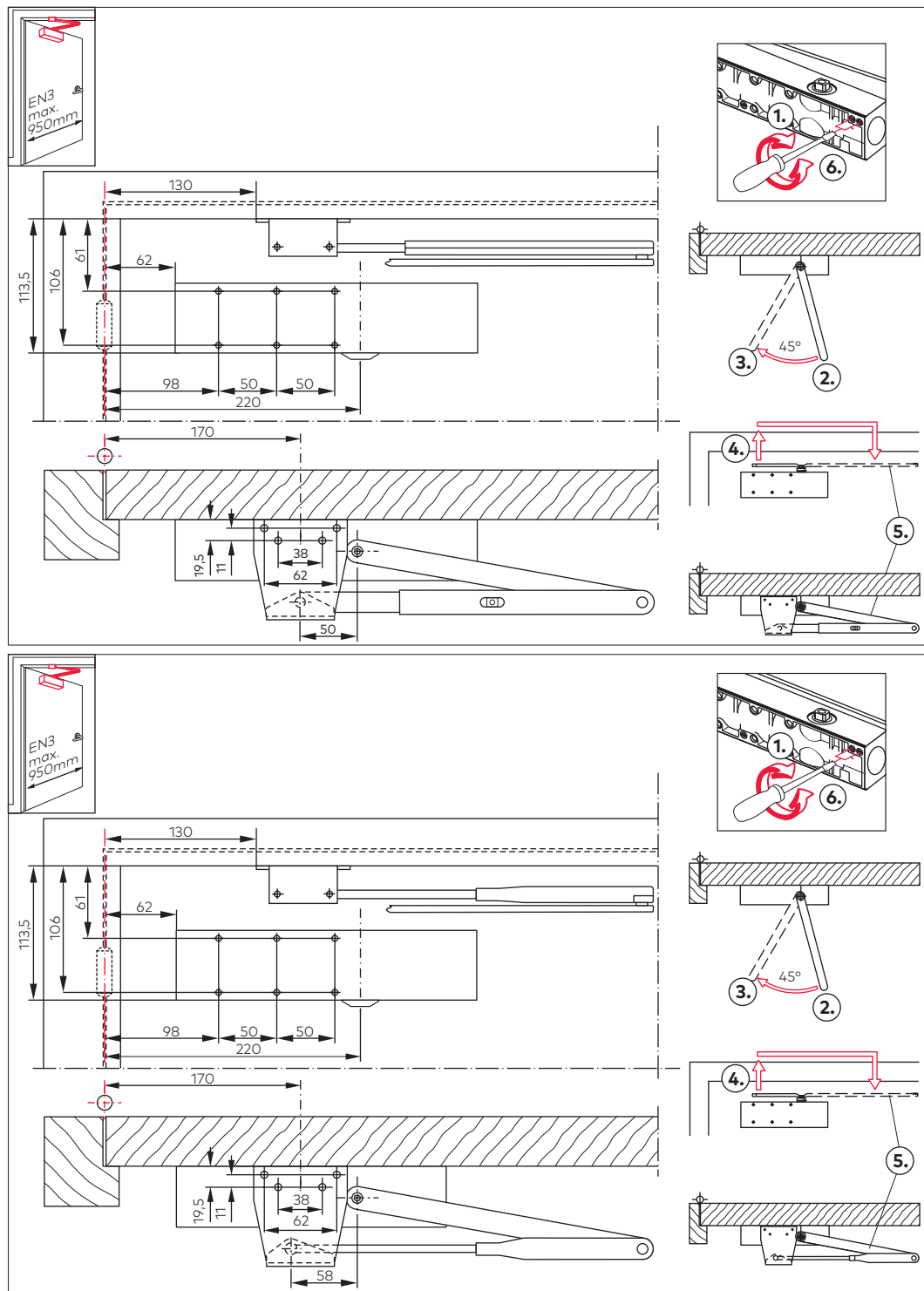

TS 73V EN 1-4

Mounting instructions

WN 057060 45532 - 2022-05

EN