

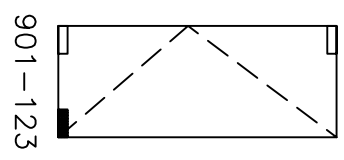

# GLASS FABRICATION DETAIL

NEW ITEM NO.	OLD ARTICLE NO.	PT. NO.
901-123	(7 351.3)	AR20

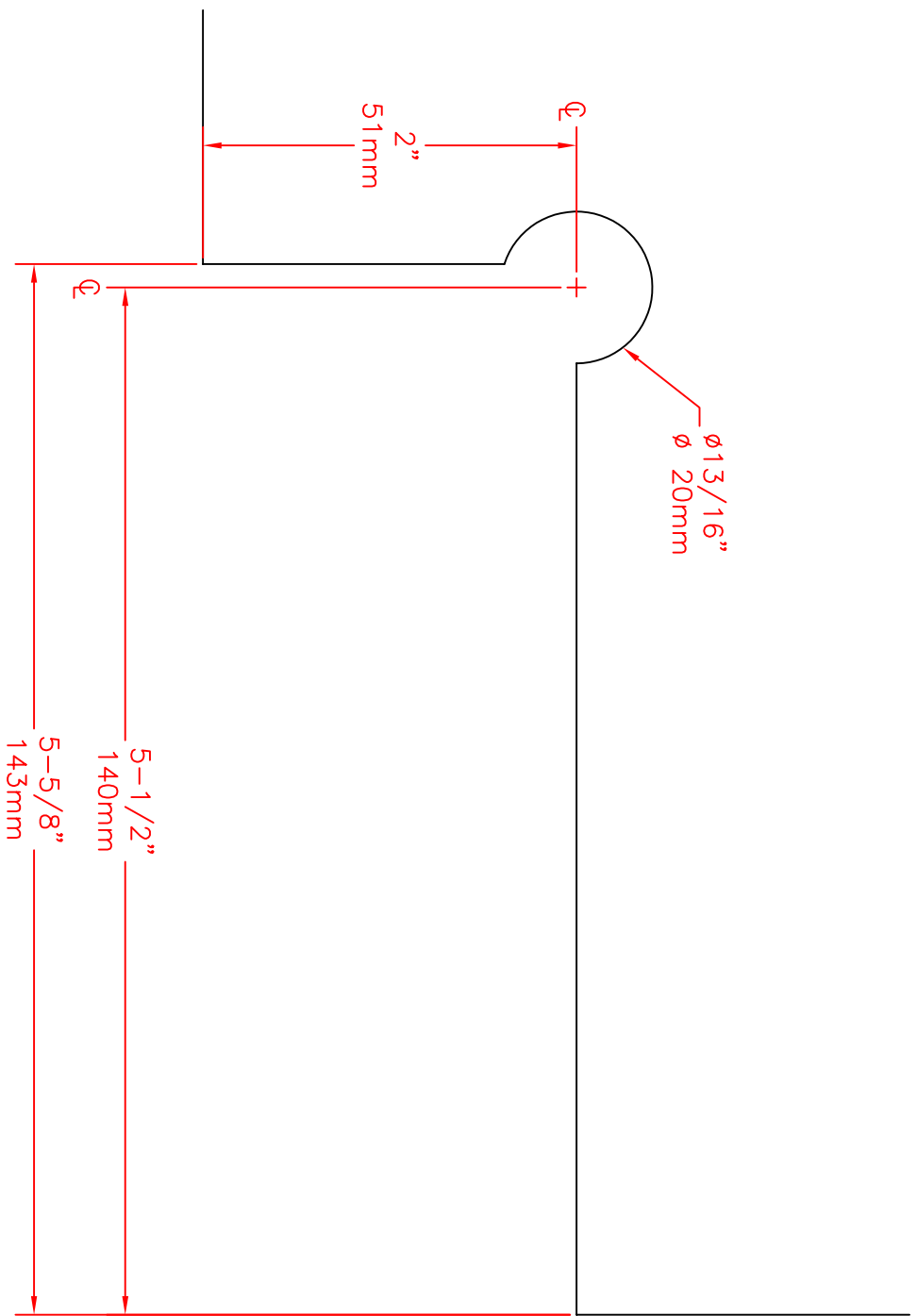

REF.: 1SE-GS15	Date	Revision
SCALE: FULL		
DATE: 12/7/98		



# GLASS FABRICATION DETAIL

NEW ITEM NO.

OLD ARTICLE NO.

PT. NO.

901-123	(7 351.3)	AR20
---------	-----------	------

3/4" GLASS THICKNESS

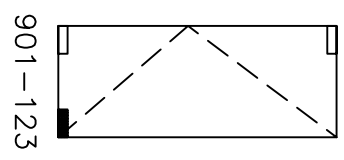
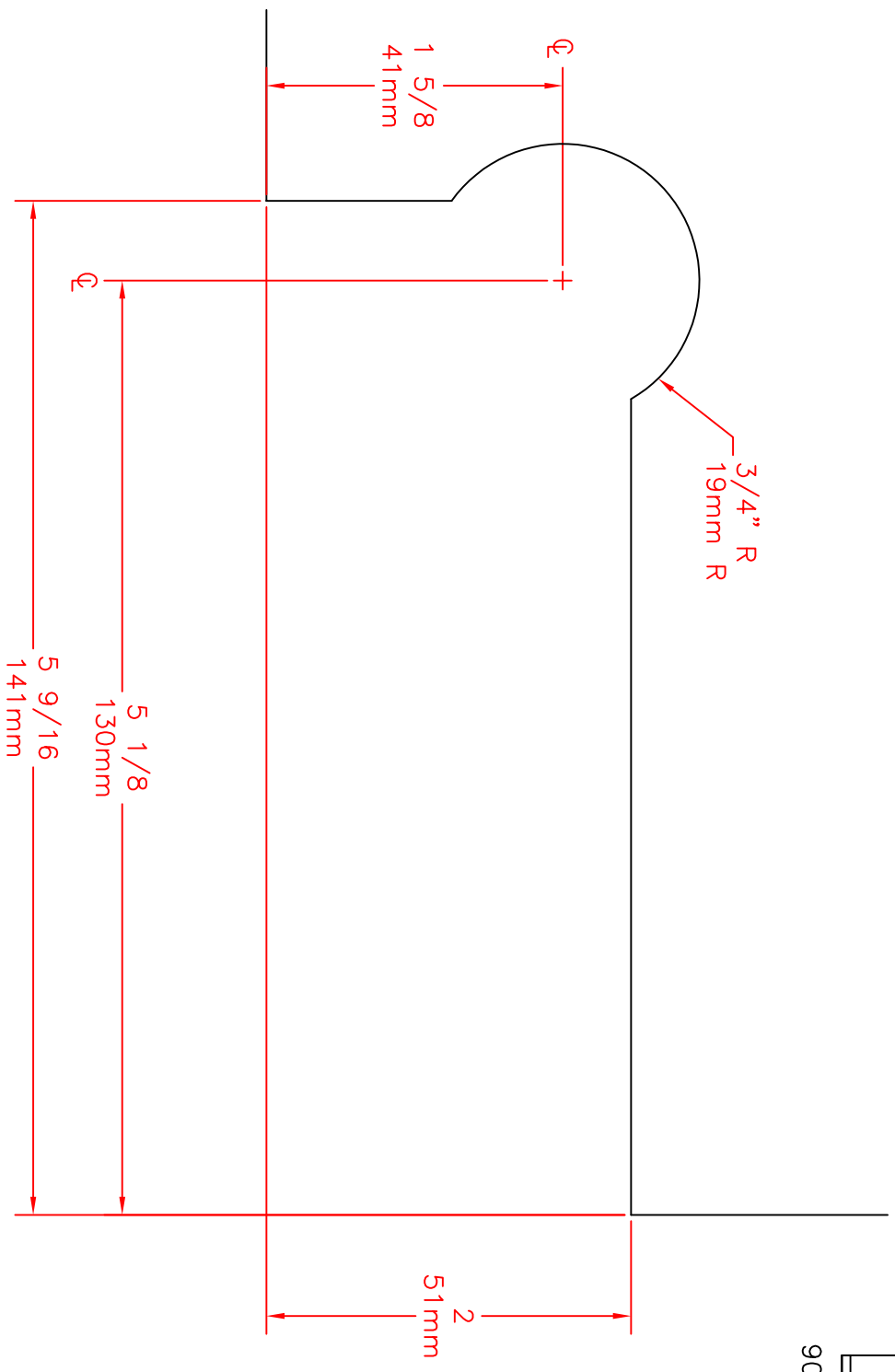

REF.: 1SE-GS20	Date	Revision
SCALE: FULL		

# GLASS FABRICATION DETAIL

NEW ITEM NO.	OLD ARTICLE NO.	PT. NO.
901-123	(7 351.3)	AR20

\* for use when the patch lock is not used on the corner of the glass

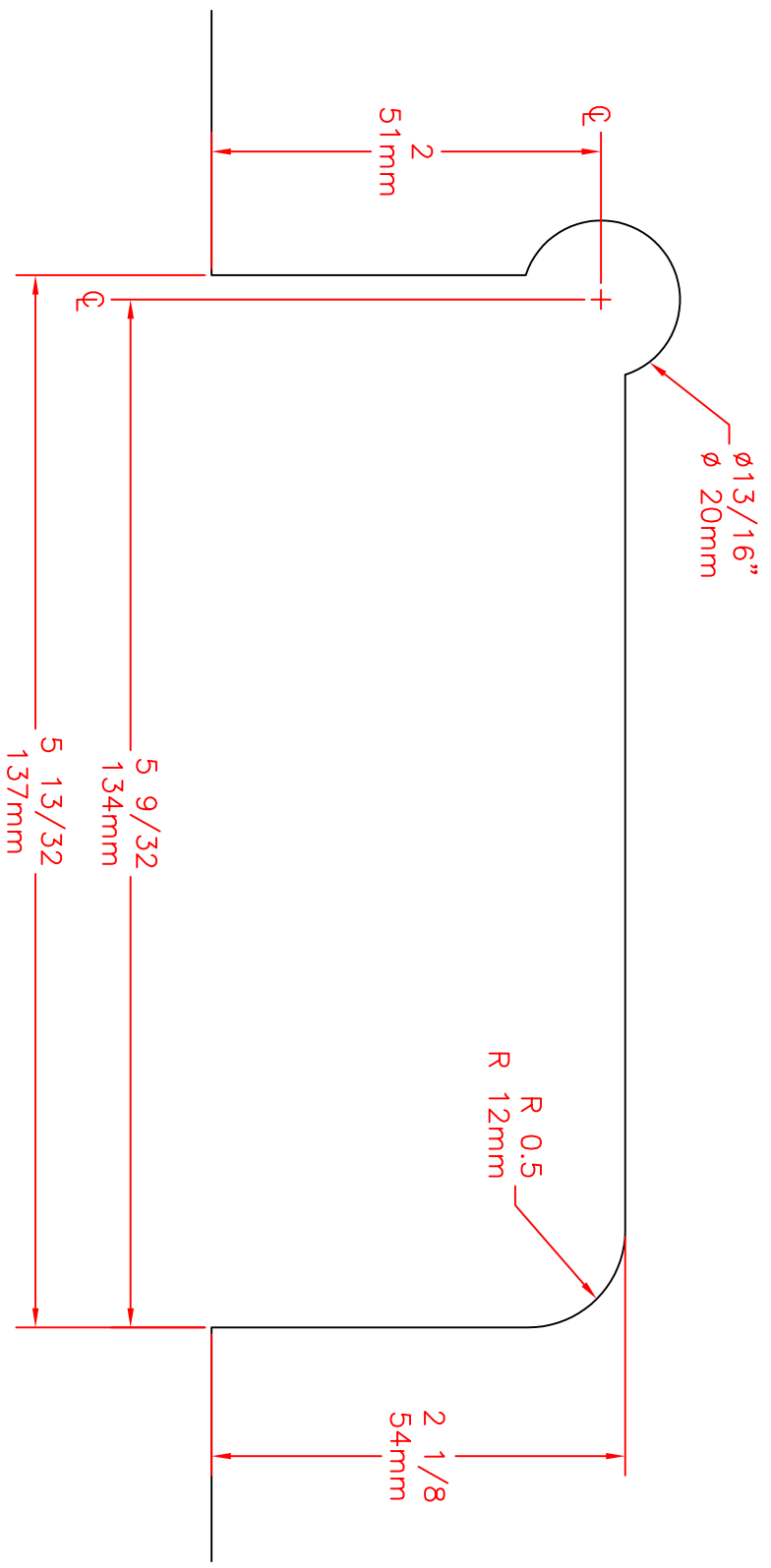
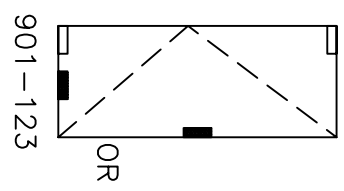

REF.: 1SE-GS22	Date	Revision
SCALE: FULL		
DATE: 4/20/01		

# GLASS FABRICATION DETAIL

NEW ITEM NO.	OLD ARTICLE NO.	PT NO.
901-123	(7 351.3)	AR20

3/4" GLASS THICKNESS

\*for use when the patch lock is not used on the corner of the glass\*

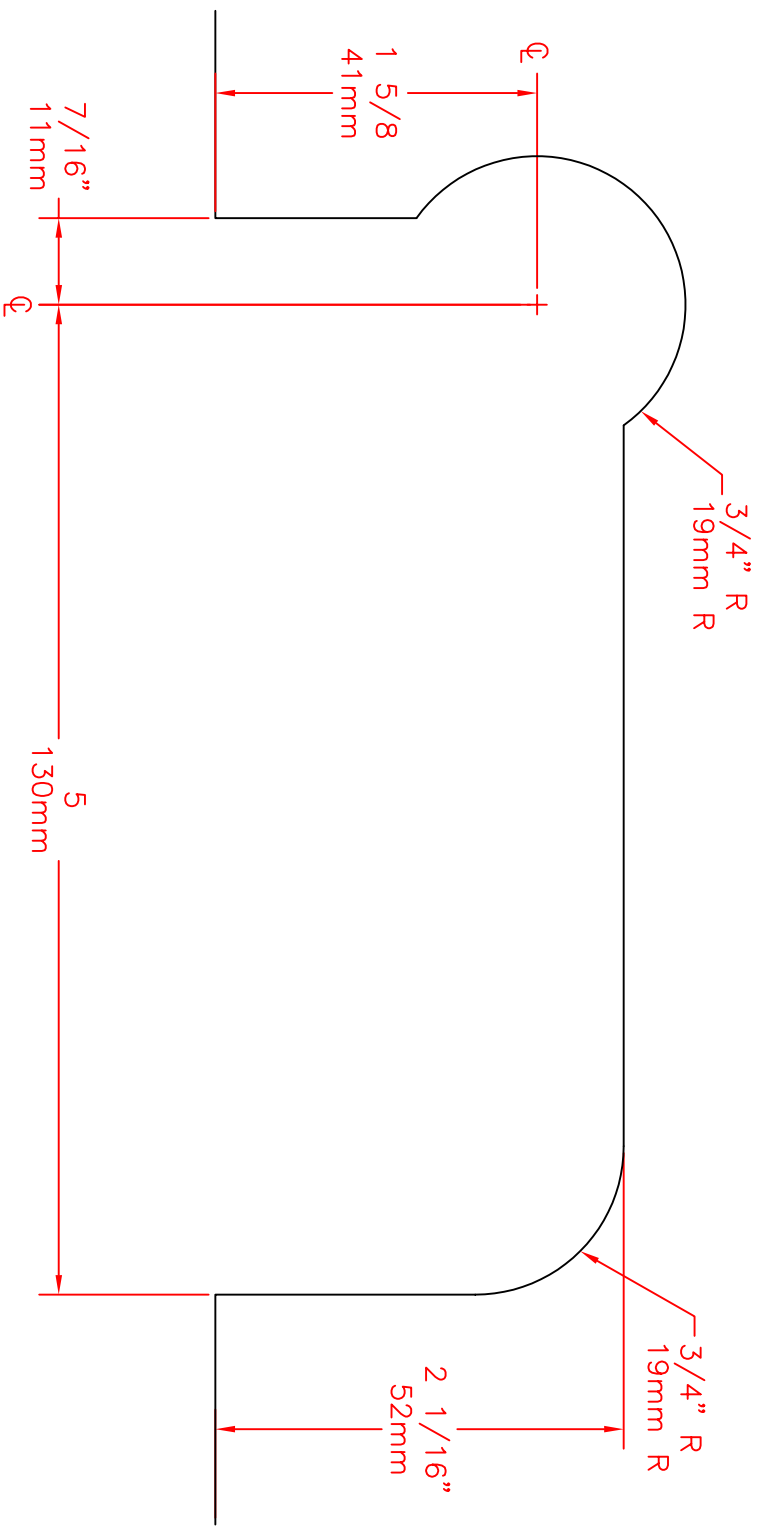
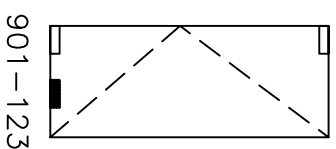

REF.: 1SE-GS31	Date	Revision
SCALE: FULL		