

WN 057631 45532
09/11

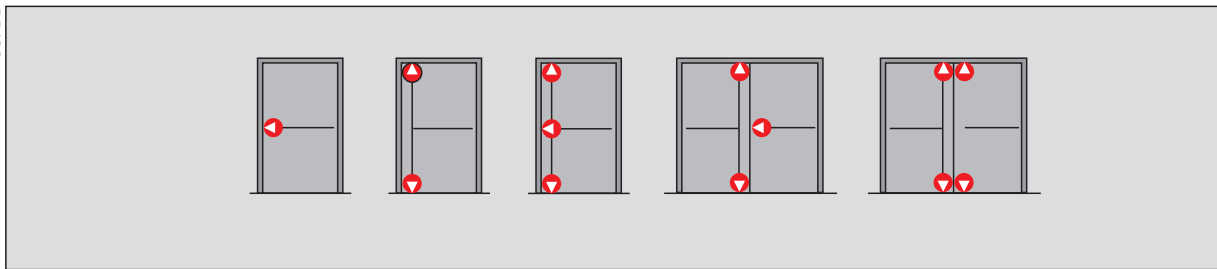

PHA 2000

1-Punkt Verriegelung
single-point locking

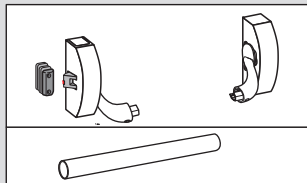

Exit Pad

1-Punkt Verriegelung
single-point locking

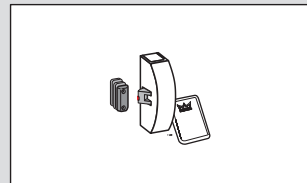

ohne
Aussen-
beschlag

without
external
fitting

Glas Kit A

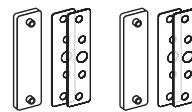

PHT Mini

Glas Kit B (DIN-L)
Glas Kit C (DIN-R)

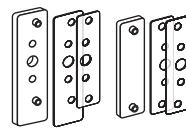

2 / 3-Punkt Verriegelung
2/3-point locking

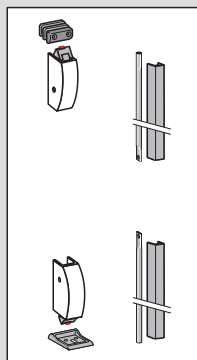

Glas Kit D

Glas Kit E

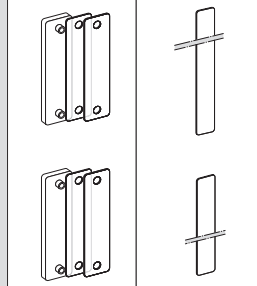

Glas Kit F



2-Punkt Verriegelung
2-point locking

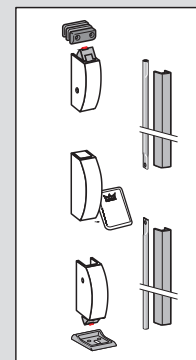

CE	10									
	1121 - CPD-AAA029	3	7	6	A	1	4	2	2	A
EN 1125:2008	3	7	6	B	1	4	2	2	A	A
Dangerous substances: None										

CE	10									
	1121 - CPD-ABB038	3	7	6	A	1	4	4	2	B
EN 179:2008	3	7	6	B	1	4	4	2	B	A
Dangerous substances: None										

PHA 2000/Exit Pad an 1-flügeligen Ganzglastüren
 PHA 2000/Exit Pad on single leaf all glass doors

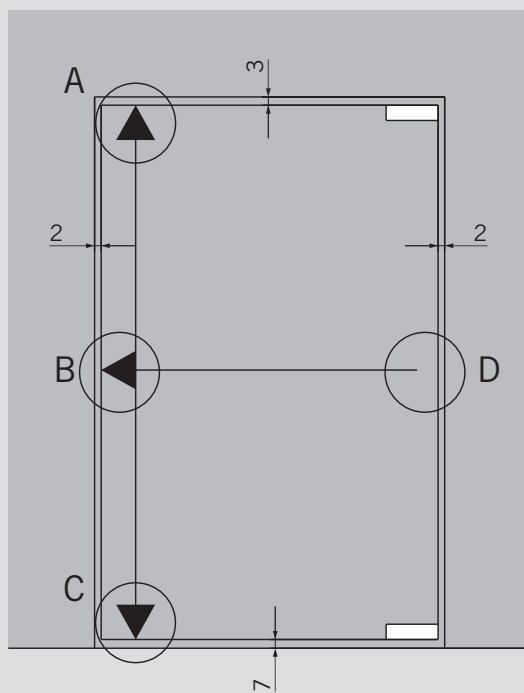
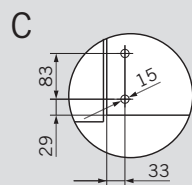
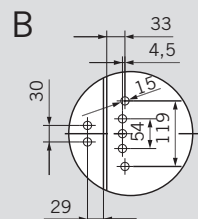
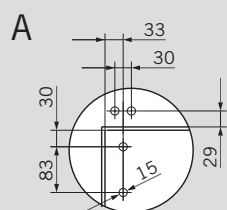

D nur bei PHA 2000
 only PHA 2000

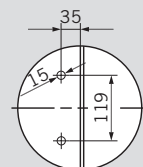

PHA 2000/Exit Pad an 2-flügeligen Ganzglastüren
 PHA 2000/Exit Pad on double leaf all glass doors

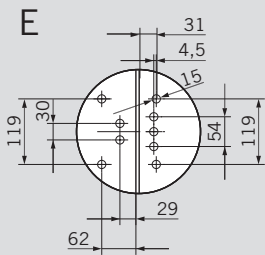
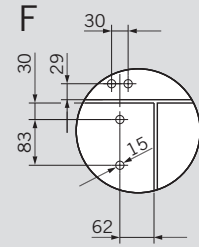

D nur bei PHA 2000
 only PHA 2000

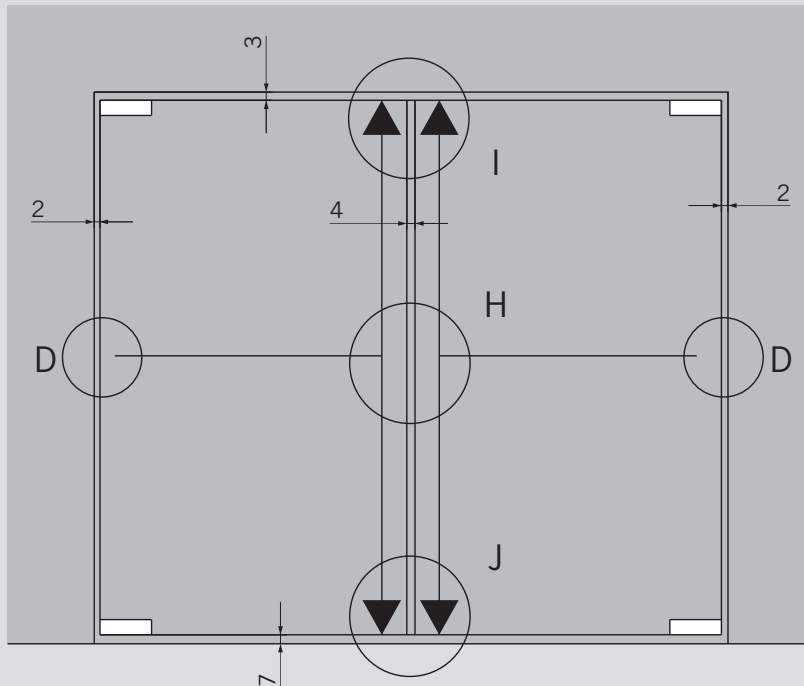
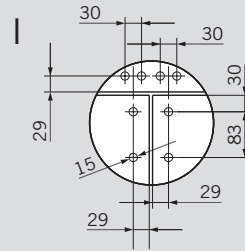
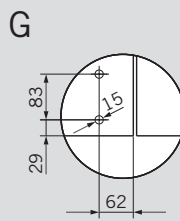
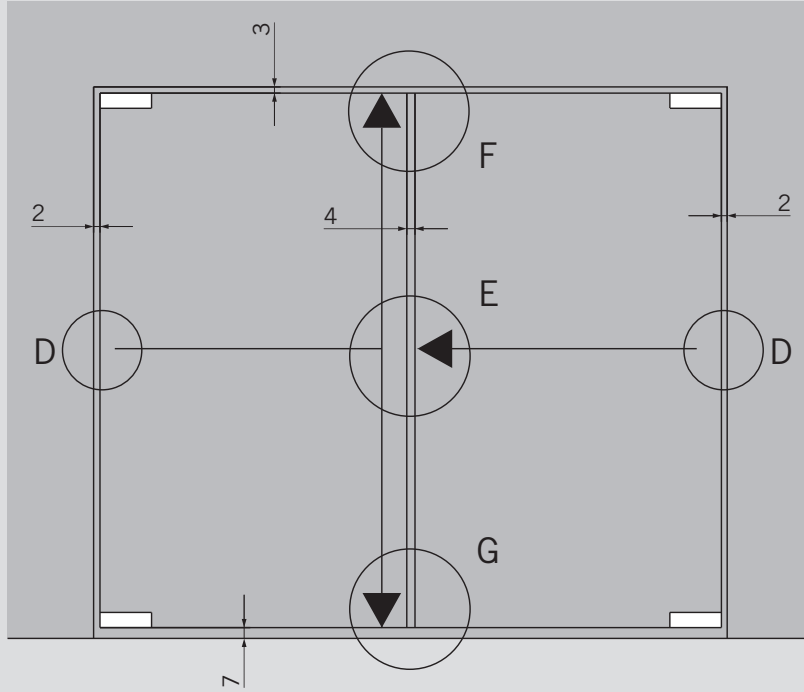
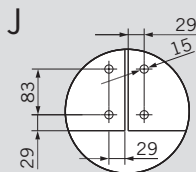
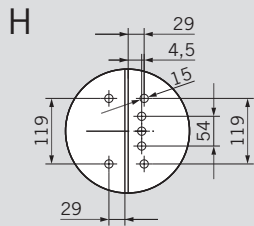
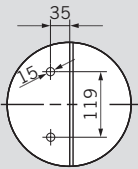

PHA 2000/Exit Pad an 1-flügeligen Glastüren mit Zarge
 PHA 2000/Exit Pad on single leaf glass doors with frame

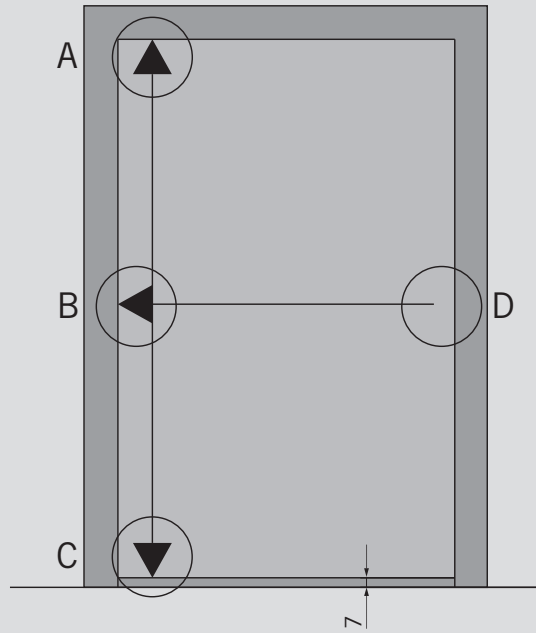
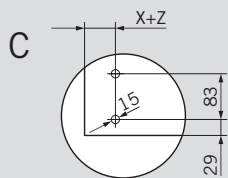
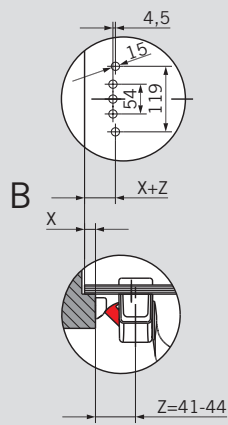
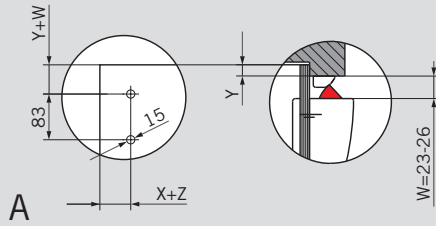

D nur bei PHA 2000
 only PHA 2000

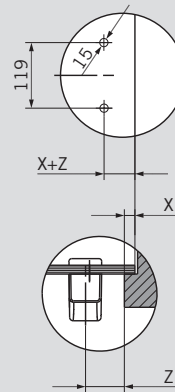

PHA 2000/Exit Pad an 2-flügeligen Glastüren mit Zarge
 PHA 2000/Exit Pad on double leaf glass doors with frame

