

# ADA square & round push plates (4.5")

## Automatic swinging doors



### Features & benefits

- 1/16" thick stainless steel for maximum durability.
- Concealed fasteners to minimize vandalism.
- Complete kits available including plates, mounting boxes, and optional wireless devices for ease of ordering.
- Various text, graphic, and ISA icon options available.
- Compatible with both surface and flush mount boxes.

### Description

ADA 4.5" round and square push plates improve overall access and seamlessly integrate with automatic door operator activation. These ADA compliant push plates are available in a variety of popular design options, including an alternate International Symbol for Access (ISA) icon.

These push plates may be hard-wired to the door operator or connected to dormakaba wireless transmitters.

### 4.5" round push plates

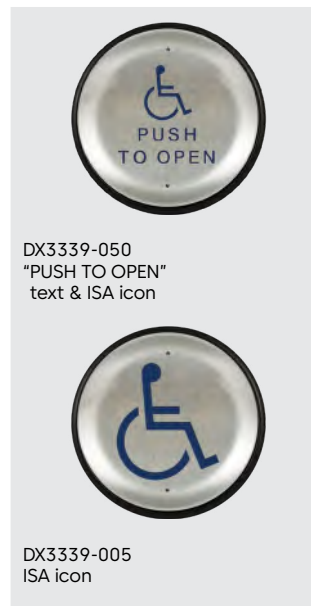

### 4.5" square push plates



## Applications

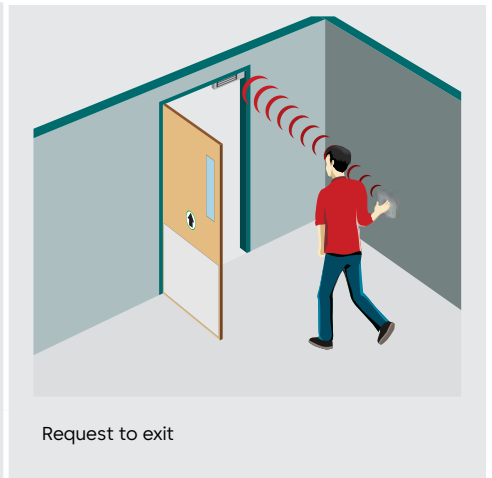
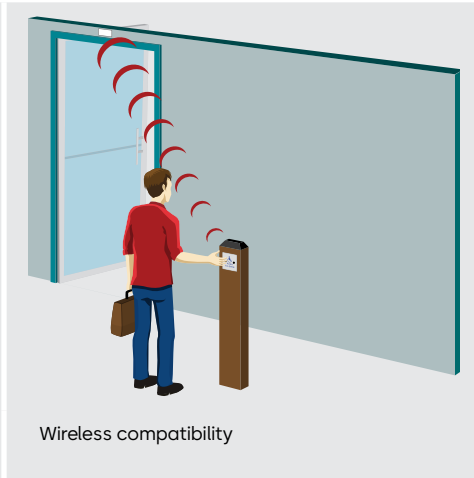
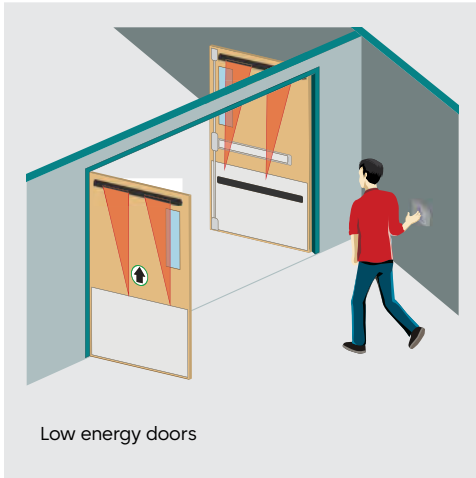

### Technical specifications

Faceplate material	16 gauge, 304 2B Stainless Steel
Backplate material	1/8" thick, Aluminum
Mounting screws	Stainless Steel, 6-32 x 1" & 8-32 x 1" Allen head size: 5/64"
Cherry switch	Single-pole, 15 A, COM / NO / NC, UL Recognized
Compatible wireless frequencies	900, 433, or 300 MHz

### 4.5" square & round push plate dimensional drawings

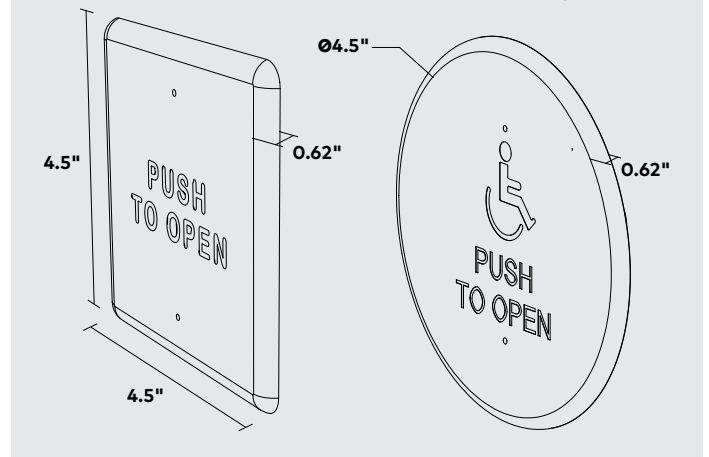

© dormakaba 2024 Information on this sheet is intended for general use only. dormakaba reserves the right to alter designs and specifications without notice or obligation.

**Any questions? We would be happy to advise you.**

Contact us at: 1-800-265-6630